



## 17-19 Kristy Court Yatala QLD

5 2 4

Some properties come to market. This one arrives. After 24 years of single-family ownership ? loved, maintained, and lived in to the fullest ? 17-19 Kristy Court is finally available, and the Gold Coast will not see another like it for a very long time.

Situated on 5,972m<sup>2</sup> of ruler-flat Gold Coast land, this is not merely a home ? it is a lifestyle statement, a legacy asset, and an irreplaceable piece of northern Gold Coast real estate. Owner-built to a personal standard that no developer ever matches, every detail of this property reflects the care of someone who intended to stay forever.

The home:

Five genuine bedrooms unfold across a floorplan that was designed for a family that actually lives ? not one built to a

**Price** : GRAND OPENING SAT @ 10.30AM  
**Building Size** : 250 sqm  
**Land Size** : 5972 sqm  
**View** : <https://www.ypa.com.au/8699312>



**Steven Spiteri**  
0423 428 079



**Sebastian Powell**  
0402 556 125

17-19 Kristy Court,  
Yatala QLD 4207,  
AUSTRALIA

Internal 274m<sup>2</sup>  
External 55m<sup>2</sup>  
Total 329m<sup>2</sup>  
Land Size 5972m<sup>2</sup>



Disclaimer: This floor plan has been prepared to provide a visual guide to the property layout and features. All measurements and details are approximate and may be subject to change. This document is not intended for legal or construction use. May not be copied, reproduced, or modified without prior written consent.

\* Denotes approximate measurements of its widest points.



Ground Floor

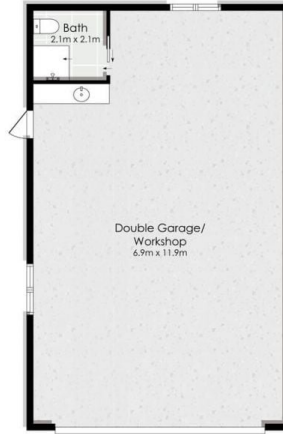

[ Not in Position ]

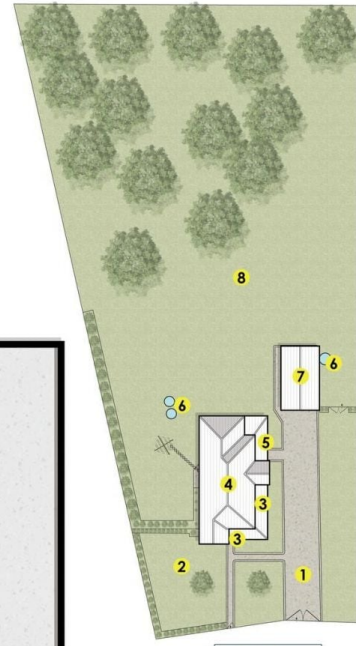

Site Plan

- Legend
1. Driveway
  2. Front Yard
  3. Covered Verandah
  4. Residence
  5. Covered Patio
  6. Water Tank
  7. Garage/Workshop
  8. Backyard

