



76 Central Avenue Altona Meadows VIC

3 2 2

YPA proudly presents 76 Central Avenue, Altona Meadows - a fantastic opportunity positioned in a highly convenient and sought-after location. Perfectly situated within walking distance to the local shopping centre, this property offers an exceptional blend of lifestyle, practicality, and future potential.

Set on a generous allotment, the home features a well-thought-out floor plan designed to maximise space and functionality. Upon entry, you are welcomed into a comfortable living area, ideal for relaxing with family or entertaining guests. Flowing seamlessly from the living zone is a dedicated dining space, positioned adjacent to a well-appointed kitchen. The kitchen offers ample bench space and storage, making it practical for everyday use while still allowing room for upgrades or personal touches.

Price : Private Sale \$799,000 - \$849,000
Land Size : 562 sqm
View : <https://www.ypa.com.au/8689068>



Vishesh Lather
0470 618 967

76 CENTRAL AVENUE, ALTONA MEADOWS, VIC

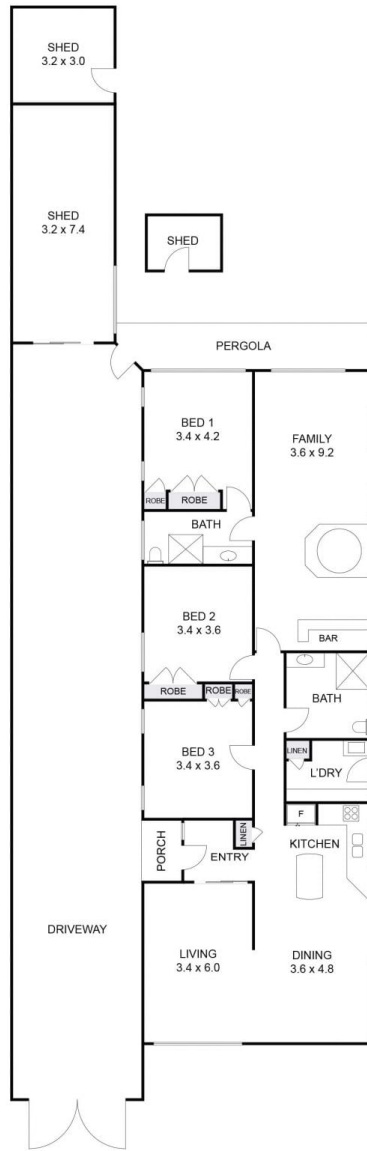

DISCLAIMER: THIS FLOOR PLAN IS A VISUAL GUIDE ONLY AND MAY CONTAIN INACCURACIES IN MEASUREMENTS, LAYOUT, ROOM NAMES OR FEATURES. NO WARRANTY IS GIVEN AS TO ITS ACCURACY. INTERESTED PARTIES MUST CONDUCT THEIR OWN DUE DILIGENCE.

ypa