



## 27 Underbank Boulevard Bacchus Marsh VIC

4 🛏 2 🚿 2 🚗

This expansive family residence delivers a thoughtful balance of space, flexibility and everyday functionality, all set on a generous 723sqm (approx.) allotment.

**Price** : \$619,000 - \$659,000  
**Land Size** : 723 sqm  
**View** : <https://www.ypa.com.au/8688872>

From the moment you step inside, the layout reveals its strength. A central living zone anchors the home, complemented by a separate lounge and an additional family room to the rear. creating three distinct living areas that cater effortlessly to both entertaining and day-to-day family life. This level of separation is increasingly sought-after, offering buyers the ability to spread out without compromise.

The kitchen is well placed at the heart of the home, seamlessly connecting to the dining domain. With ample bench space, practical storage and clear sightlines across the main living areas, it's designed for both functionality



**Shane O'Brien**  
0431 766 082



**Katelyn Taylor**  
0411 800 780

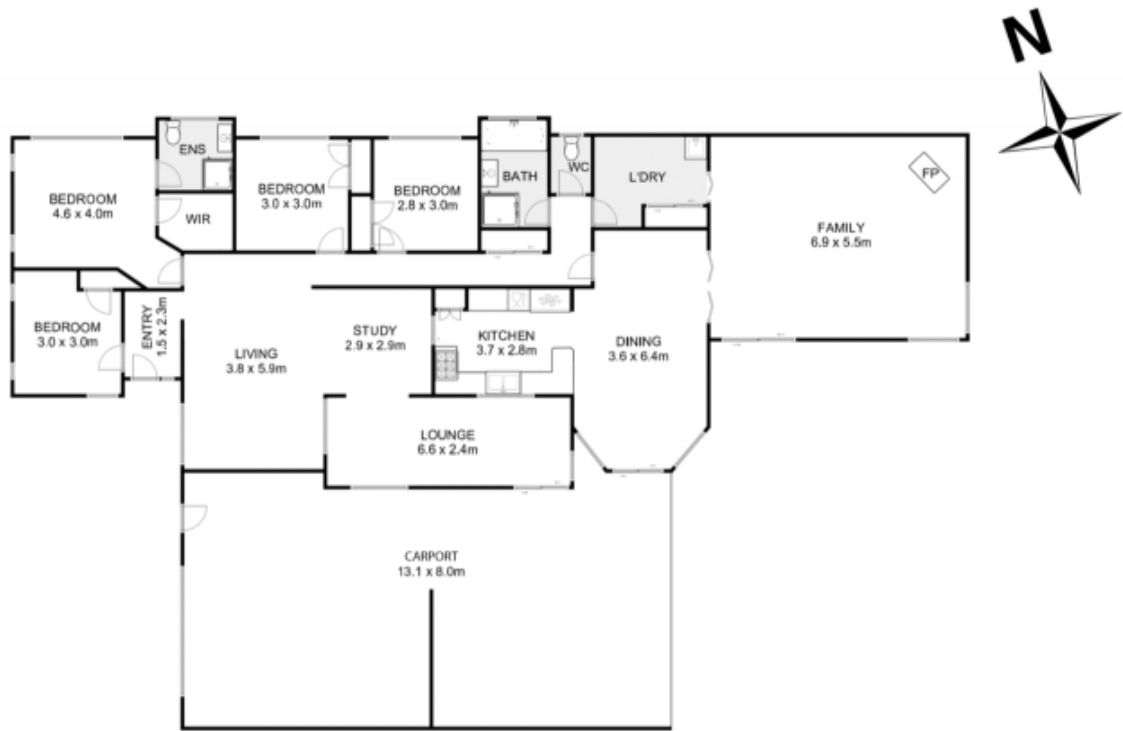

## 27 Underbank Boulevard, Bacchus Marsh

ypa

Whilst every attempt has been made to ensure the accuracy of the floor plan contained here, measurements of doors, windows, rooms and any other items are approximate and no responsibility is taken for any error, omission, or mis-statement. This plan is for illustrative purposes only and should be used as such by any prospective purchaser. The services, systems and appliances shown have not been tested and no guarantee as to their operability or efficiency can be given.

