



3 Baillie Court Bacchus Marsh VIC

3 1 2

Showcasing an impressive combination of classic and contemporary features, this home offers a sensational low-maintenance lifestyle, ideal for first-home buyers, families, or investors. Perfectly positioned in a quiet pocket of Bacchus Marsh on a large 650m² (approx.) block, it is conveniently close to schools, the local hospital, Main Street and everything else Bacchus Marsh has to offer!

From the moment you arrive, you're greeted by a gorgeous façade and beautifully designed, low-maintenance landscaping. The concrete driveway leads to the carport for practicality, while the feature lamp post and timber roof lined porch instantly capturing attention and setting the tone for the craftsmanship showcased throughout the home. As you step inside you will be impressed by a neutral colour palette set a bright and welcoming tone throughout the home. The massive open plan living area is

Price : \$669,000- \$699,000
Land Size : 657 sqm
View : <https://www.ypa.com.au/8682112>



Ryan Anders
0434 900 300



Cheyenne Kollar
0484 385 522

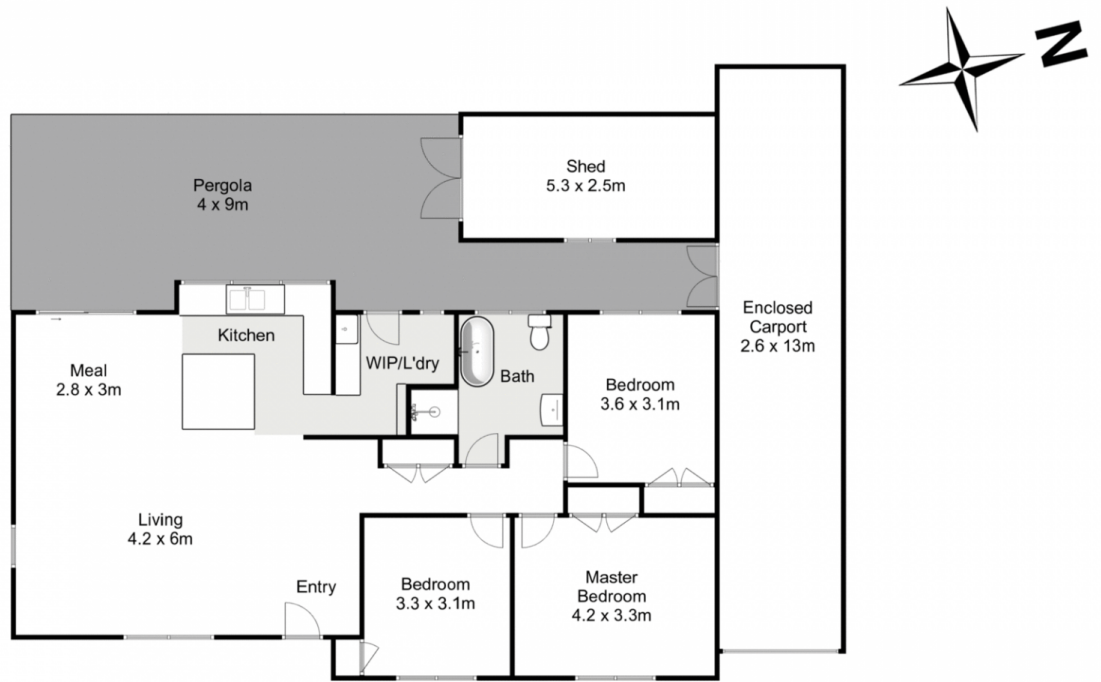

3 Baillie Court, Bacchus Marsh

Whilst every attempt has been made to ensure the accuracy of the floor plan contained here, measurements of doors, windows, rooms and any other items are approximate and no responsibility is taken for any error, omission, or mis-statement. This plan is for illustrative purposes only and should be used as such by any prospective purchaser. The services, systems and appliances shown have not been tested and no guarantee as to their operability or efficiency can be given.