



## 28 Thomson Terrace Rye VIC

3 1

ALL OFFERS WITHIN ADVERTISED RANGE CONSIDERED.

**Price** : Immediate Sale Required - \$765,000 - \$800,000

**Land Size** : 725 sqm

**View** : <https://www.ypa.com.au/8641108>

Full of warmth and relaxed coastal charm, this inviting Rye property located in the ever-popular Tyrone Foreshore pocket, offers the perfect base for easy beachside living while presenting exciting possibilities for the future.

Set on an expansive allotment measuring approximately 725m<sup>2</sup>, the property provides space, privacy and flexibility, making it ideal as a weekend retreat, holiday investment or permanent home on the Mornington Peninsula.

Inside, the home features three well-proportioned bedrooms all with newly fitted ceiling fans and black-out blinds, a light-filled living area and a central family



**Jade Springer**  
0437 410 791

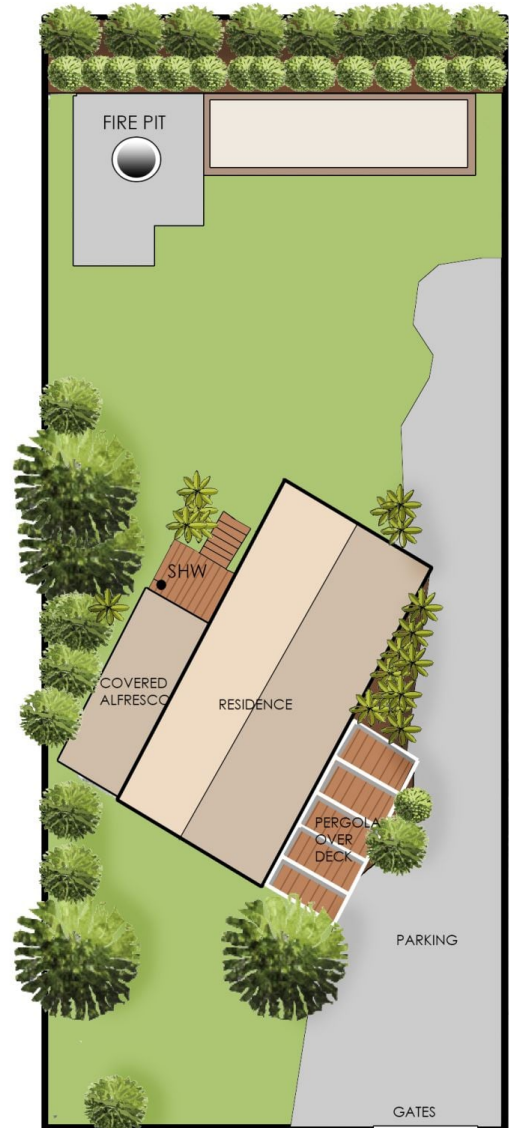

## 28 Thomson Terrace, Rye

The floor plan is provided for general information and illustrative purposes only. All measurements, dimensions, and layouts are approximate and may vary from the actual property. While every effort has been made to ensure accuracy, no responsibility is taken for any error, omission, or misstatement. Prospective buyers should not rely solely on the floor plan and are encouraged to conduct their own inspections and verify all details independently. The design and content of this floor plan remain the property of DND Floor Plans. ©