



3 Edward Street Rye VIC

3  1  1 

Located just 500 metres from the Rye foreshore, 3 Edward Street presents an outstanding opportunity to secure a charming home in a truly serene setting.

Surrounded by established Moonah trees that create a canopy like setting and positioned on a generous allotment, the property offers privacy, space and a genuine Peninsula holiday feel.

Original in character and beautifully maintained, the home showcases timber flooring throughout and a practical, flowing layout designed for relaxed living. The central living room features a wood burning fire for cosy winter evenings, along with a split system for year round comfort. Large windows enhance the connection to the outdoors, drawing in natural light and leafy outlooks.

Price : \$ 870,000
Land Size : 805 sqm
View : <https://www.ypa.com.au/8638770>



Jade Springer
0437 410 791

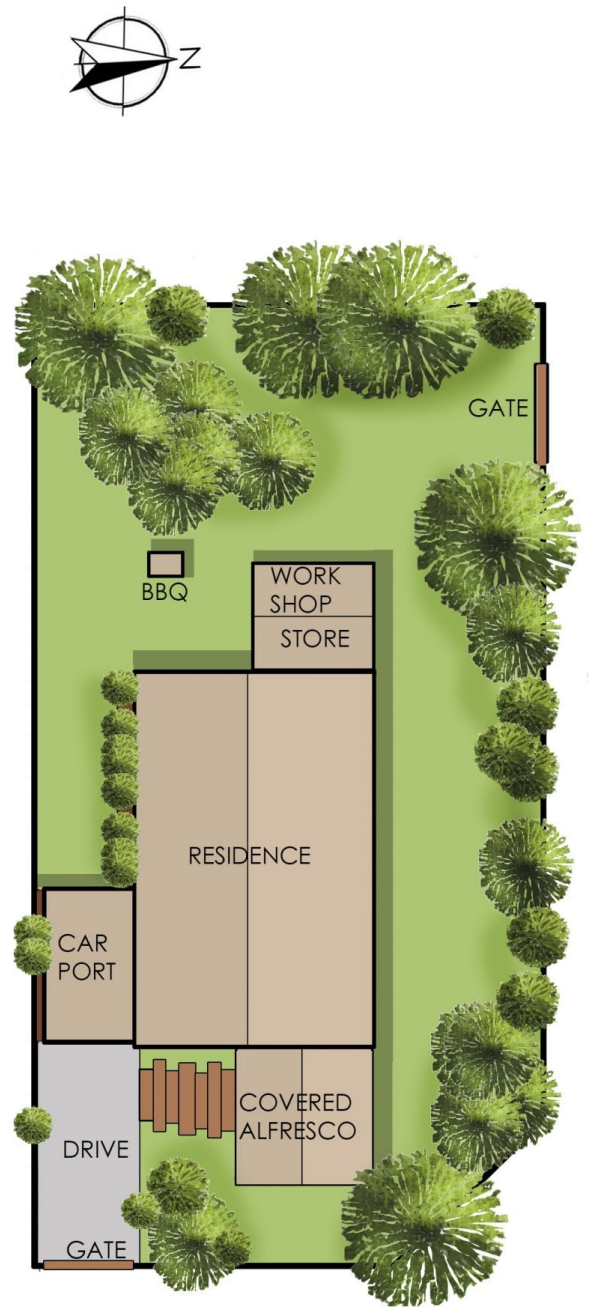

3 Edward Street, Rye

The floor plan is provided for general information and illustrative purposes only. All measurements, dimensions, and layouts are approximate and may vary from the actual property. While every effort has been made to ensure accuracy, no responsibility is taken for any error, omission, or misstatement. Prospective buyers should not rely solely on the floor plan and are encouraged to conduct their own inspections and verify all details independently. The design and content of this floor plan remain the property of DND Floor Plans. ©