



2 Lillian Street Cranbourne VIC

4  2  4 

Positioned in a quiet and convenient pocket of Cranbourne, 2 Lillian Street presents an exceptional opportunity for families seeking space, comfort, and convenience on a generous 613sqm (approx.) allotment.

Price : UNDER CONTRACT
Land Size : 613 sqm
View : <https://www.ypa.com.au/8627352>

Designed with flexibility in mind, this well-appointed four-bedroom residence features a highly sought-after ground floor bedroom complete with private ensuite ? perfect for multi-generational living, guests, or a private master retreat.

Upstairs, the remaining bedrooms are generously sized and serviced by a central bathroom, offering comfortable accommodation for the whole family.

Key Features:

GROUND FLOOR



FIRST FLOOR



SITE PLAN

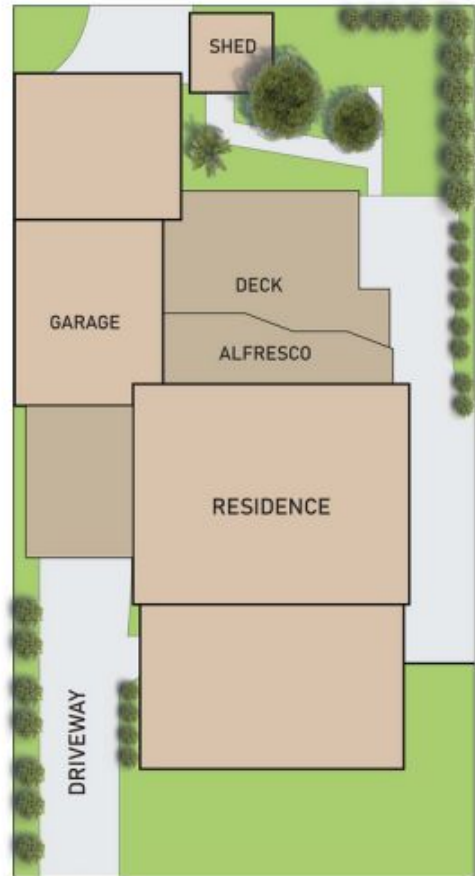

2 LILLIAN STREET, CRANBOURNE

FLOOR AND SITE PLAN IS FOR ILLUSTRATIVE PURPOSES ONLY AND NOT TO SCALE. THE VENDOR, AGENCY OR SUPPLIER MAKE NO GUARANTEE, WARRANTY OR REPRESENTATION AS TO THE ACCURACY OF ANY INFORMATION CONTAINED HEREIN AND THE COMPLETENESS OF THE FLOOR PLANNED WILL ACCEPT NO LIABILITY FOR ITS ACCURACY. INTERESTED PARTIES ARE ADVISED TO MAKE THEIR OWN INDEPENDENT ENQUIRIES.

ypa

Produced by **BLOOM MEDIA AGENCY**