

13 Lucent Ave Wollert VIC

4  2  2 

Perfectly positioned in one of Wollert's growing Aurora estate family-friendly pocket, this stylish four-bedroom townhouse delivers contemporary comfort, space and convenience across a thoughtfully designed floor-plan.

Ideal for first home buyers, investors or growing families, the home offers four generously sized bedrooms, all with built-in robes, serviced by two modern bathrooms. The master bedroom features its own private ensuite, while a total of three toilets throughout the home adds extra practicality for busy households.

The light-filled open plan living and dining area flows seamlessly into a well-appointed kitchen complete with quality appliances, ample storage and sleek finishes ? perfect for everyday living and entertaining alike.

Price : \$ 600,000

View : <https://www.ypa.com.au/8621636>



Carla Primiano
0407 183 331



Manu Kumar
0435 456 004

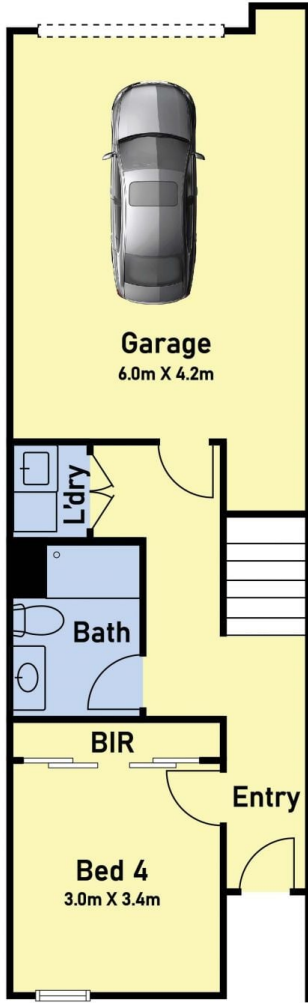

Ground Floor

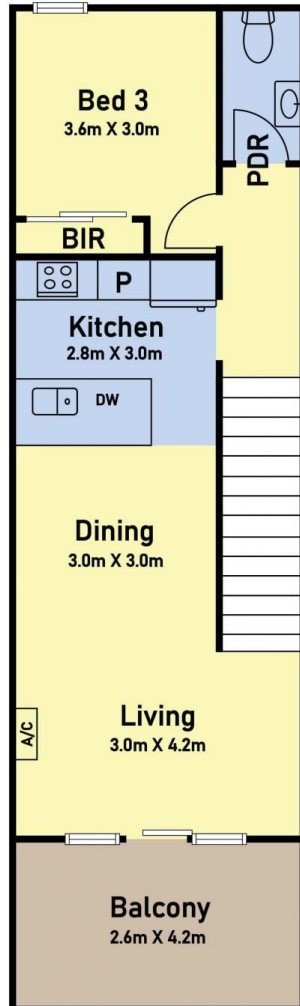

First Floor

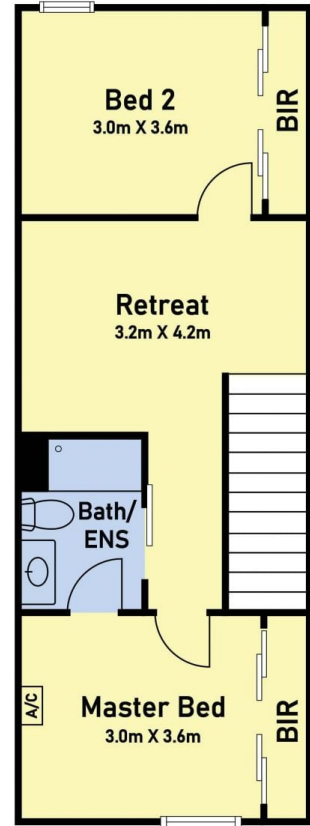

Second Floor



NOTE: SIZE AND DIMENSIONS ARE INDICATIVE AND SHOULD NOT BE TAKEN AS DEFINITE.