



## 6 Highbury Road Rye VIC

3 2 2

Set behind a pretty white timber fence and secure electric gate in a quiet Rye setting, 6 Highbury Road delivers comfort, character and an effortless connection to the coast. Beautifully presented and thoughtfully enhanced, the home offers a welcoming atmosphere that feels both intimate and surprisingly spacious from the moment you arrive.

Inside, polished hardwood timber floors create warmth underfoot, while soft downlights and custom under island lighting create a refined ambience throughout. The kitchen is stylish and practical, appointed with stone benchtops, electric cooking and a dishwasher, all flowing naturally into the dining and living zones. The dining area comfortably accommodates an eight seat table, making it ideal for family meals and relaxed entertaining while still retaining the home's cosy feel.

**Price** : \$ 920,000  
**Land Size** : 724 sqm  
**View** : <https://www.ypa.com.au/8619856>



**Katrina Talarico**  
0420 778 404



**Ben Nutbean**  
0413 125 996

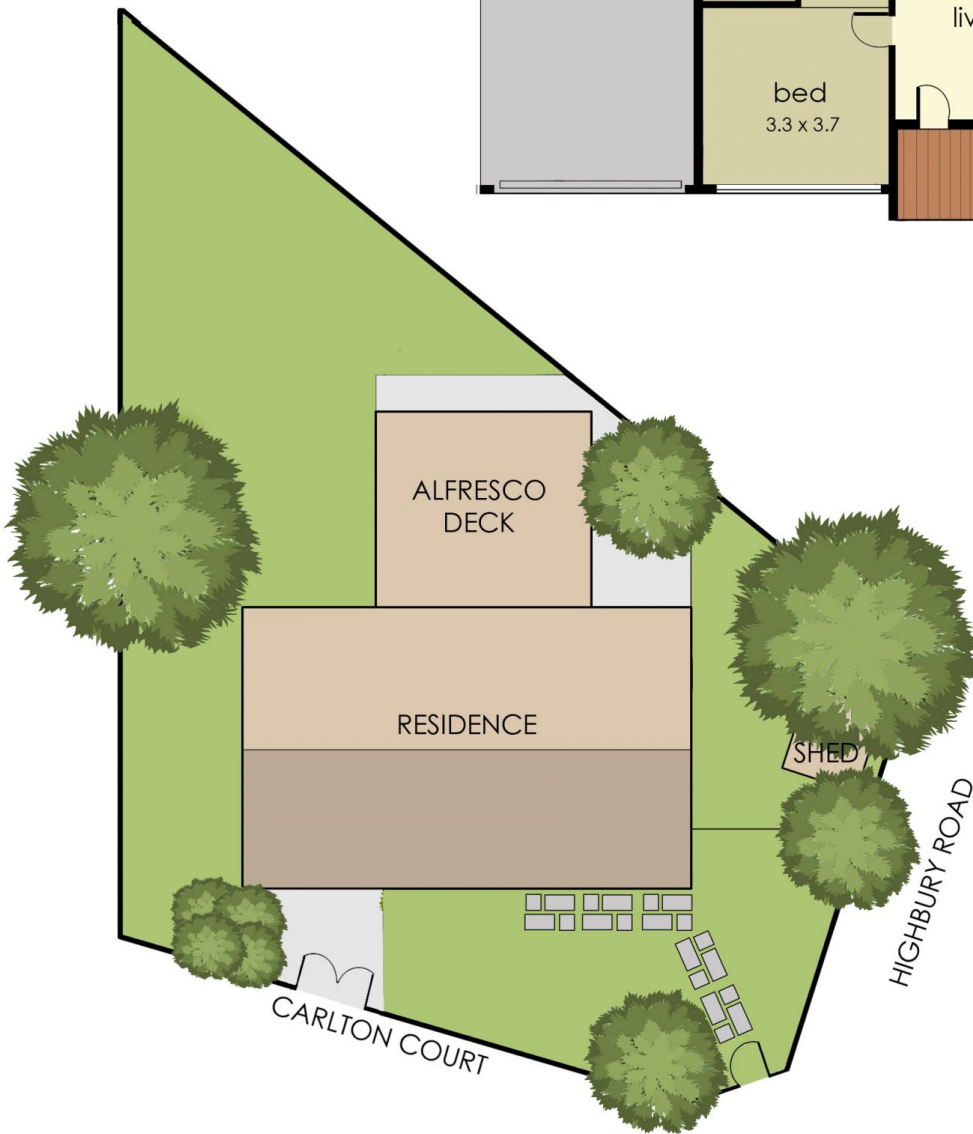

- Internal living area approx: 11 squares
- Carport area approx: 4 squares
- Alfresco/ Verandah area approx: 5 squares
- Total area approx: 20 squares

## 6 Highbury Road, Rye

The floor plan is provided for general information and illustrative purposes only. All measurements, dimensions, and layouts are approximate and may vary from the actual property. While every effort has been made to ensure accuracy, no responsibility is taken for any error, omission, or misstatement. Prospective buyers should not rely solely on the floor plan and are encouraged to conduct their own inspections and verify all details independently. The design and content of this floor plan remain the property of DND Floor Plans. ©