



21 Carlslake Avenue Blairgowrie VIC

3 1 1

Quietly positioned within one of Blairgowrie's most tightly held coastal streets, 21 Carlslake Avenue presents a thoughtful vision of modern living, where sustainability and serenity exist in perfect balance. Fully electric and future focused, the home is powered by a comprehensive solar system and supported by a 10kw battery, offering an effortless sense of self sufficiency and long term peace of mind.

Set on a prized corner allotment with dual access from both Carlslake Avenue and Darwin Street, the arrival is gentle and considered. A freshly painted exterior introduces a residence that has been thoughtfully maintained, where every element feels intentional and enduring. As you move inside, the home opens gradually, guided by natural light and an intuitive sense of flow.

A sunny north east atrium draws warmth deep into the

Land Size : 646 sqm

View : <https://www.ypa.com.au/8614296>



Tony Talarico
0420 778 401



Katrina Talarico
0420 778 404

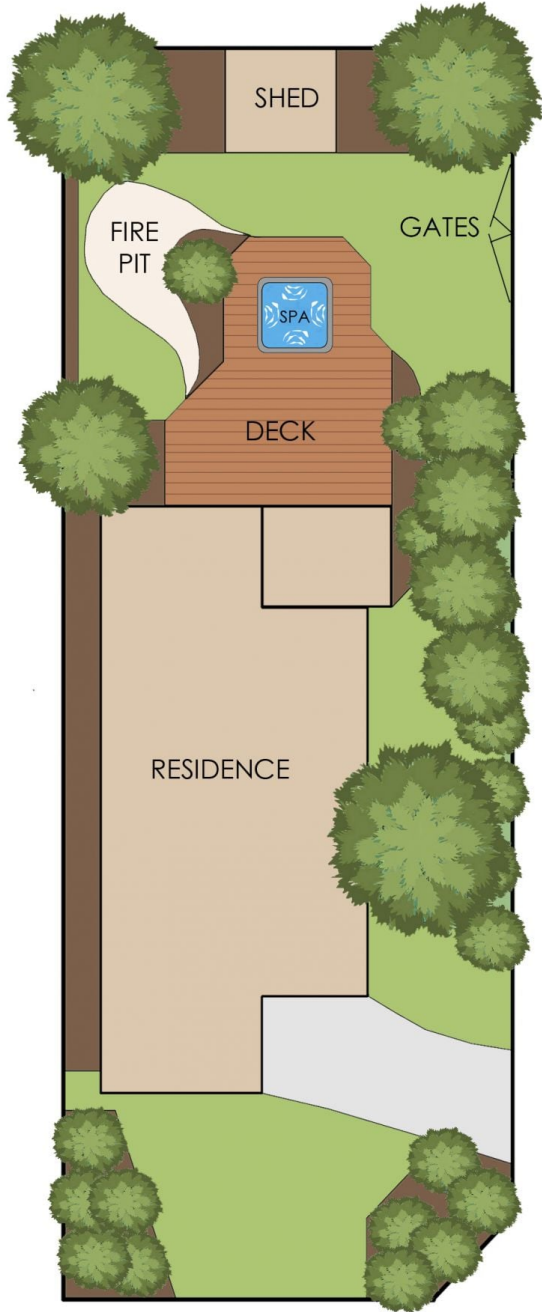

Internal living area
approx: 12 squares

Decking area
approx: 4 squares

Carport area
approx: 2.5 squares

Total area
approx: 18.5 squares

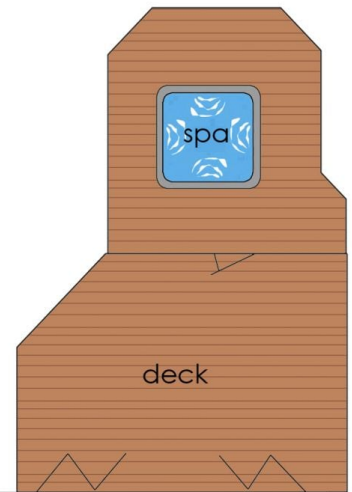

21 Carslake Avenue, Blairgowrie

The floor plan is provided for general information and illustrative purposes only. All measurements, dimensions, and layouts are approximate and may vary from the actual property. While every effort has been made to ensure accuracy, no responsibility is taken for any error, omission, or misstatement. Prospective buyers should not rely solely on the floor plan and are encouraged to conduct their own inspections and verify all details independently. The design and content of this floor plan remain the property of DND Floor Plans. ©