



## 3B Fifeshire Drive Hoppers Crossing VIC

4 2 2

Design excellence, quality finishes, and everyday versatility come together at 3B Fifeshire Drive, Hoppers Crossing, proudly presented by YPA Wyndham City. Set in the tightly held Kingston Gardens Estate on approximately 441sqm (approx. 27 squares), this standout standalone residence delivers the space and flexibility families love, with the added bonus of smart upgrades that support long-term comfort and value.

From the moment you arrive, a wide entry creates an immediate sense of scale, leading to a light-filled front study-perfect for working from home, a kids' retreat, or a potential fourth bedroom option. The home offers three genuinely generous bedrooms, with the master suite featuring a full ensuite and walk-in robe, while the remaining bedrooms include walk-in robes with fitted rails and shelving-ideal for effortless day-to-day living.

**Price** : \$ 756,000  
**Land Size** : 441 sqm  
**View** : <https://www.ypa.com.au/8606621>



**Abdul Merabi**  
0424 263 506



**Ibrahim Ahmed**  
0449 119 577

# 3B Fifeshire Drive, Hoppers Crossing

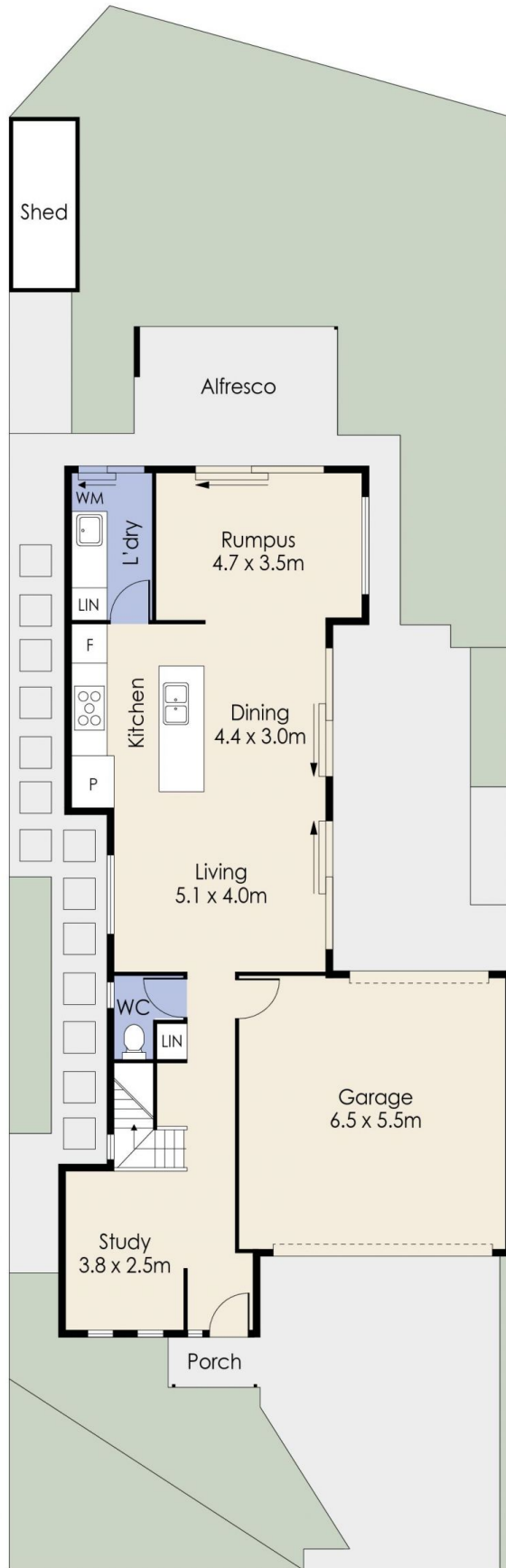

Ground Floor

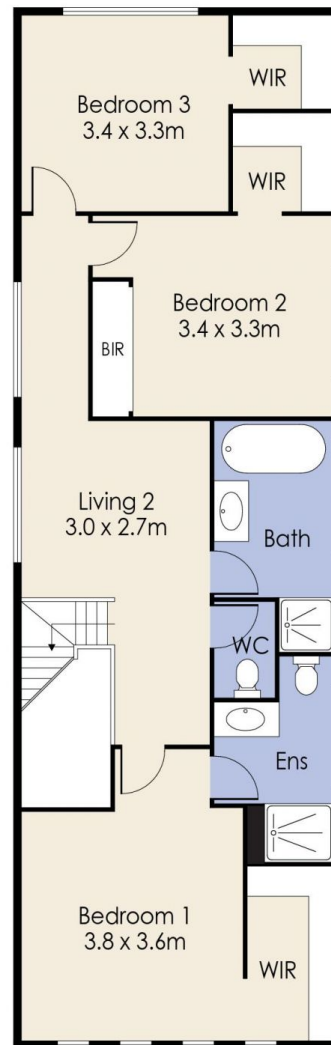

First Floor

Whilst every attempt has been made to ensure the accuracy of the floor plan contained here, measurements of doors, windows, rooms and any other items are approximate and no responsibility is taken for any error, omission, or mis-statement. This plan is for illustrative purposes only and should be used as such by any prospective purchaser. The services, systems and appliances shown have not been tested and no guarantee as to their operability or efficiency can be given.