



## 13 Bingin Place Craigieburn VIC

3 2 2

Auction Location: On Site

Welcome to your new home in the heart of Craigieburn, where comfort meets convenience. This inviting 3-bedroom, 2-bathroom residence is perfect for first home buyers and large families alike. The home boasts a master suite with an ensuite and walk-in robe, alongside fully renovated slate grey stone bathrooms. An open-plan living area with 3-meter ceilings floods the space with natural sunlight, creating a warm and welcoming atmosphere.

Step outside to discover a large pergola perfect for entertaining, complete with a woodfire and outdoor fire feature. The expansive backyard includes fruit trees, a kids' playhouse, and plenty of room for gardening. A second functioning kitchen with stainless steel appliances adds to the home's versatility. The property is also equipped with

**Price** : \$ 800,000  
**Land Size** : 577 sqm  
**View** : <https://www.ypa.com.au/8588449>



**Kiah Fahey**  
0493 852 775



**Mohammed El Hawli**  
0466 882 117

Floor Plan



Site Plan

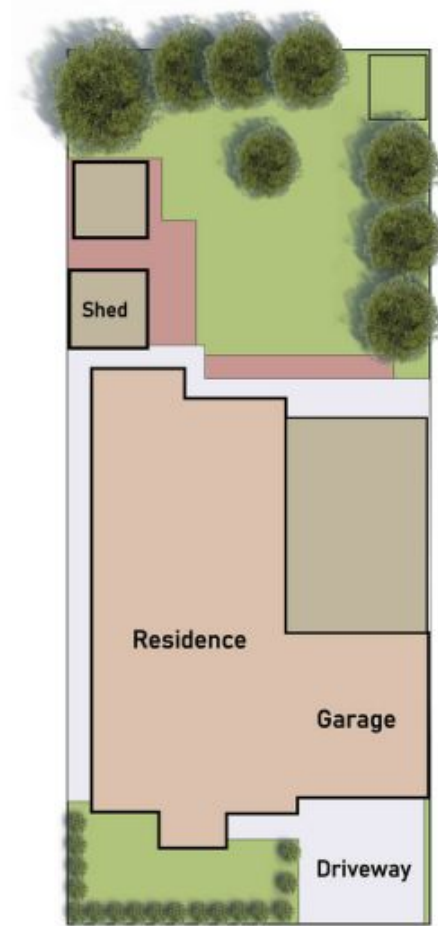

## 13 Bingin Place, Craigieburn

The floor and site plan are provided for illustrative purposes only and are not to scale. While every effort has been made to ensure accuracy, neither the vendor, agency, supplier, nor PSM1005studios.au makes any warranty, guarantee, or representation regarding the accuracy, reliability, or completeness of the information contained herein. No responsibility or liability will be accepted for any errors, omissions, or discrepancies. Interested parties are strongly advised to conduct their own independent investigations and enquiries prior to making any decisions.