



## 67 Lady Nelson Drive Sorrento VIC

3 2 2

Perfectly positioned within the prestigious Settlers Cove estate, 67 Lady Nelson Drive offers an exceptional opportunity to secure a beautifully maintained coastal residence in one of Sorrento's most exclusive enclaves. Surrounded by the natural beauty, sophistication, and effortless coastal charm that define the area, this elegant three bedroom home delivers the kind of lifestyle many dream of, but few are fortunate enough to call their own.

Bathed in glorious northern sun, the home opens to a bright and beautifully appointed interior, anchored by a superb stone-topped kitchen. A large island bench, soft closing cabinetry, Miele appliances (dishwasher, wall oven, microwave, rangehood and gas hot plates) create a stylish and functional hub ideal for both effortless everyday living and memorable summer entertaining.

**Price** : \$ 1,780,000  
**Land Size** : 785 sqm  
**View** : <https://www.ypa.com.au/8565899>



**Jade Springer**  
**0437 410 791**



**Tony Talarico**  
**0420 778 401**

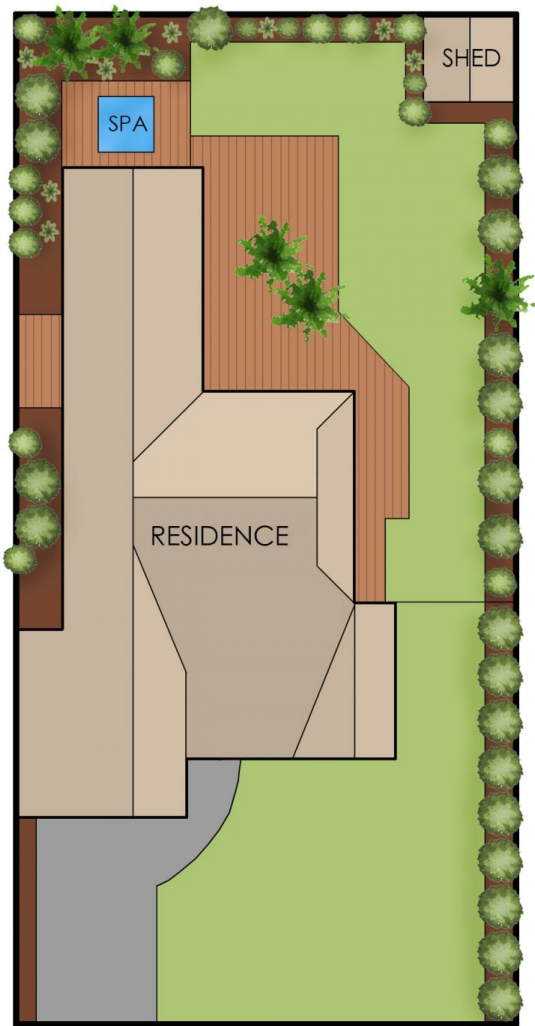

Internal living area  
approx: 16 squares

Garage area  
approx: 4 squares

Decking area  
approx: 10 squares

Total area  
approx: 30 squares



## 67 Lady Nelson Drive, Sorrento

The floor plan is provided for general information and illustrative purposes only. All measurements, dimensions, and layouts are approximate and may vary from the actual property. While every effort has been made to ensure accuracy, no responsibility is taken for any error, omission, or misstatement. Prospective buyers should not rely solely on the floor plan and are encouraged to conduct their own inspections and verify all details independently. The design and content of this floor plan remain the property of DND Floor Plans. ©