

3 The Creek Approach Craigieburn VIC

4 🏠 3 🛏

This is the one. Set in Craigieburn's most coveted creekside pocket, this is the definitive lifestyle Home your family deserves. Proudly poised on a landmark 538sqm corner block, this magnificent double-storey home delivers a rare combination of space, quality, and lifestyle, with serene parkland and walking trails right at your doorstep.

Step inside to a bright, expansive floorplan featuring three distinct living zones for ultimate family flexibility. The ground floor, finished with gleaming, high-quality tiling, flows from the main living and dining areas to the well-appointed kitchen at the heart of the home.

Ascend the solid timber staircase to a true family sanctuary, offering a second living room?perfect as a kids' retreat?and a separate, dedicated study/work-from-home area. The four spacious bedrooms are finished with warm

Price : \$ 810,000
Building Size : 245 sqm
Land Size : 538 sqm
View : <https://www.ypa.com.au/8547522>



Dev Sareen
0470 353 148



Mohammed El Hawli
0466 882 117

Ground Floor



First Floor

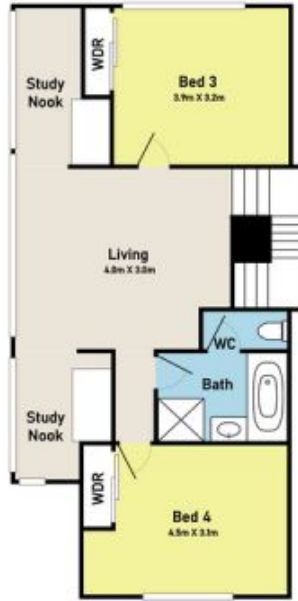

Site Plan



3 The Creek Approach, Craigieburn



The floor and site plan are provided for illustrative purposes only and are not to scale. While every effort has been made to ensure accuracy, neither the vendor, agency, supplier, nor PSM1005studios.au makes any warranty, guarantee, or representation regarding the accuracy, reliability, or completeness of the information contained herein. No responsibility or liability will be accepted for any errors, omissions, or discrepancies. Interested parties are strongly advised to conduct their own independent investigations and enquiries prior to making any decisions.