



14/181 Bay Street Port Melbourne VIC

2 🏠 2 🚗 1 🚗

This stunning home showcases modern design and sophisticated living across multiple levels. The master bedroom offers a generous walk-in wardrobe and a sleek en-suite, while the second bedroom includes ample built-in storage. Additional under-stair storage provides clever functionality.

Ascending to the next level, you'll find a beautifully appointed contemporary kitchen featuring Miele appliances and a stylish breakfast bar. The adjoining open-plan living and dining area is expansive and inviting, complete with a magnificent gas log fireplace and split-system heating and cooling for year-round comfort.

Step out onto the impressive balcony, where you can admire the blend of Port Melbourne's rich heritage and vibrant modern developments. With cafés, restaurants,

View : <https://www.ypa.com.au/8541794>



Bassam Tofaili
0477 972 229

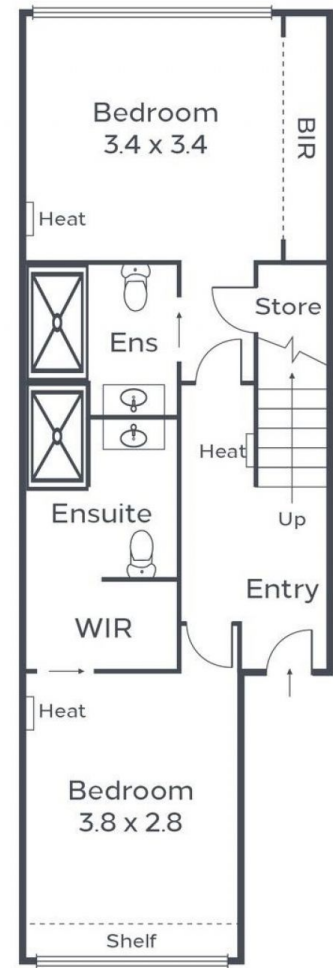

Ground Floor

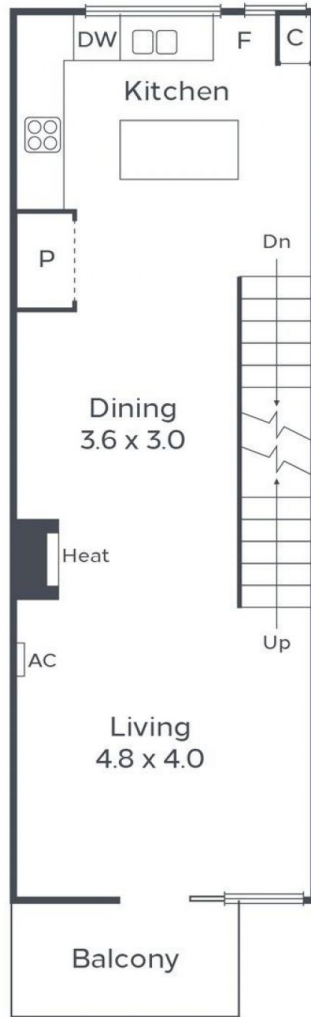

First Floor



(Not In Position)

