



8 Grandview Avenue Rye VIC

3 1 2

Ideally positioned just 750 metres from the pristine shores of Port Phillip Bay, this thoughtfully updated four bedroom home captures the relaxed essence of coastal living with all the conveniences of modern comfort. Perfect as a permanent residence, beachside getaway or investment, it offers an easy care lifestyle in one of Rye's most sought after pockets.

Step inside and be welcomed by light-filled interiors, where large picture windows frame leafy garden views and fill the home with natural warmth. The flowing single level layout features hardwood timber flooring and tiles throughout, with a spacious living and dining area that's perfect for family living or relaxed entertaining.

At the heart of the home, the updated galley style kitchen combines function and style, complete with a subway tile

Price : \$ 910,000
Land Size : 696 sqm
View : <https://www.ypa.com.au/8539013>



Jade Springer
0437 410 791



Kelsie Janssen
0417245204



Internal living area
approx: 14 squares

Decking area
approx: 4 squares

Total area
approx: 18 squares

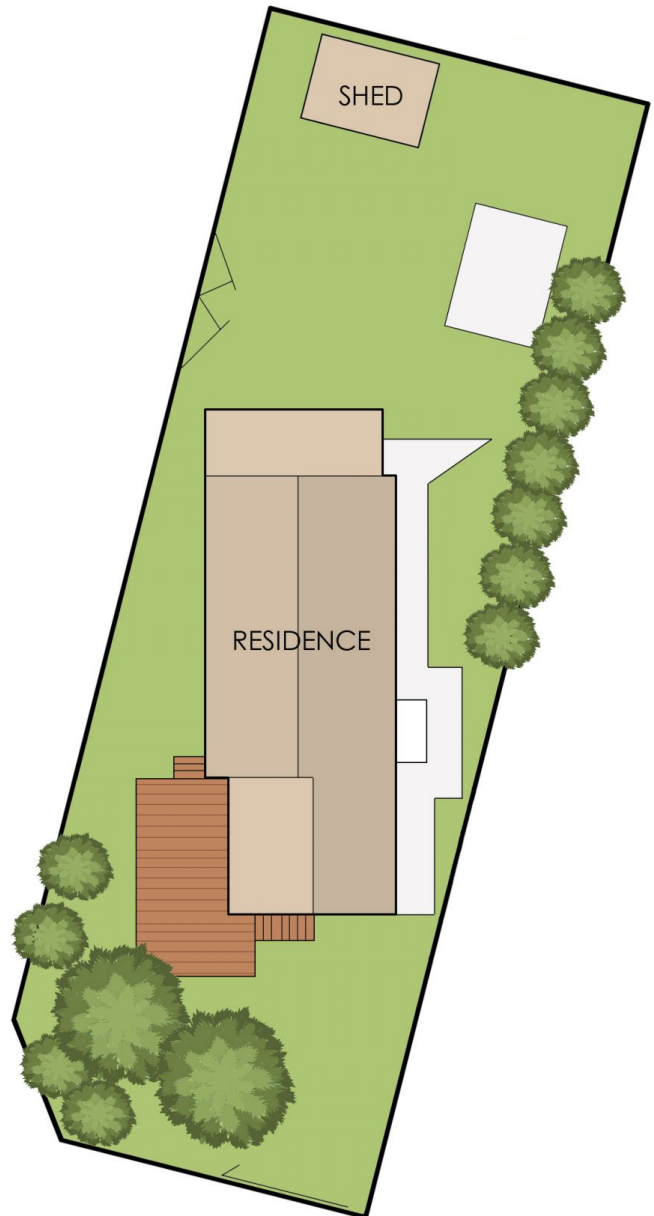

8 Grandview Avenue, Rye

The floor plan is provided for general information and illustrative purposes only. All measurements, dimensions, and layouts are approximate and may vary from the actual property. While every effort has been made to ensure accuracy, no responsibility is taken for any error, omission, or misstatement. Prospective buyers should not rely solely on the floor plan and are encouraged to conduct their own inspections and verify all details independently. The design and content of this floor plan remain the property of DND Floor Plans. ©