

6 Nebo Court Werribee VIC

4  2  4 

Perfectly positioned in a quiet and tightly held court, this well-established home at 6 Nebo Court, Werribee sits proudly on a generous 620m² block, offering exceptional space, comfort, and long-term investment value. Designed with functionality and lifestyle in mind, this residence is ideal for investors seeking strong rental returns in one of Werribee's most family-friendly pockets.

Combining a spacious interior layout with practical outdoor zones, this home caters perfectly to growing families and quality tenants who appreciate low-maintenance living with plenty of room to move. The generous land size also offers future potential for improvement or extension (STCA), further adding to its investment appeal.

As you enter, you're welcomed by a warm and inviting formal lounge that sets the tone for relaxed living. This

Price : \$ 675,000

View : <https://www.ypa.com.au/8529639>



Manjot Bawa
0433 853 301

6 NEBO COURT, WERRIBEE

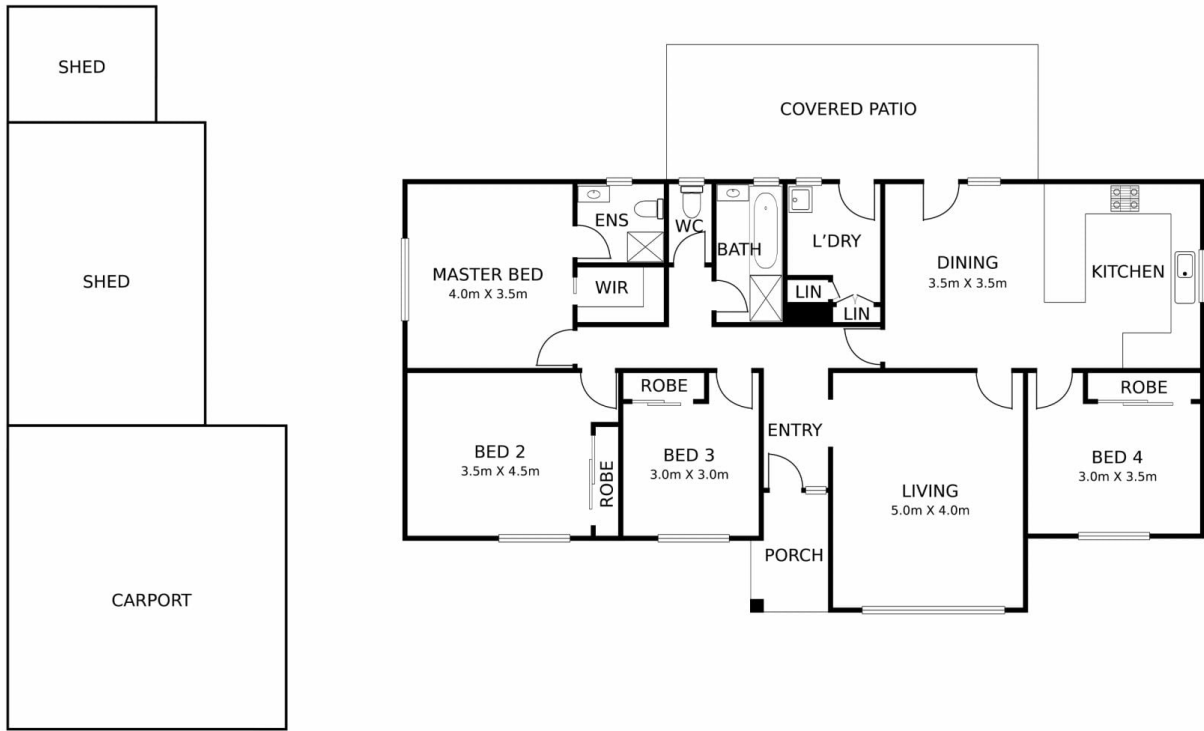

(NOT IN POSITION)

DISCLAIMER: PLEASE NOTE FLOOR PLAN IS INDICATIVE ONLY AND NOT DRAWN TO EXACT SCALE.
ALL DIMENSIONS ARE APPROX AND FOR ILLUSTRATION ONLY.

