



42 Pegasus Road CRANBOURNE WEST VIC

3  2  2 

Nestled in the heart of Cranbourne West, this ultra-affordable rental offers a fantastic opportunity for families or professionals seeking comfort and convenience. This charming house boasts three spacious bedrooms and two well-appointed bathrooms, providing ample space for everyone. The inclusion of a study ensures the flexibility needed for remote work or focused study sessions. With a double garage, you'll have plenty of room for vehicles or additional storage.

Cranbourne West is a thriving suburb known for its welcoming community and excellent amenities. You'll find a variety of parks and recreational facilities nearby, perfect for weekend family outings or a leisurely stroll. The area is also well-served by public transport, making commuting to Melbourne CBD or surrounding suburbs a breeze. Nearby schools include Cranbourne West Primary School

View : <https://www.ypa.com.au/8501758>



Pulkit Khetarpal
0413 500 090



Hemant Dobriyal
0424 938 441

Floor Plan

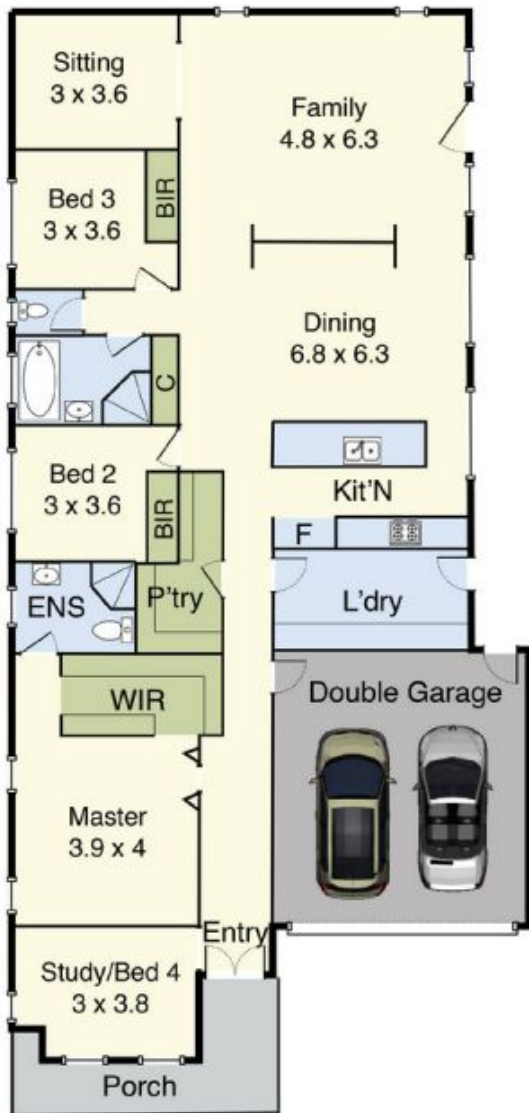

Site Plan

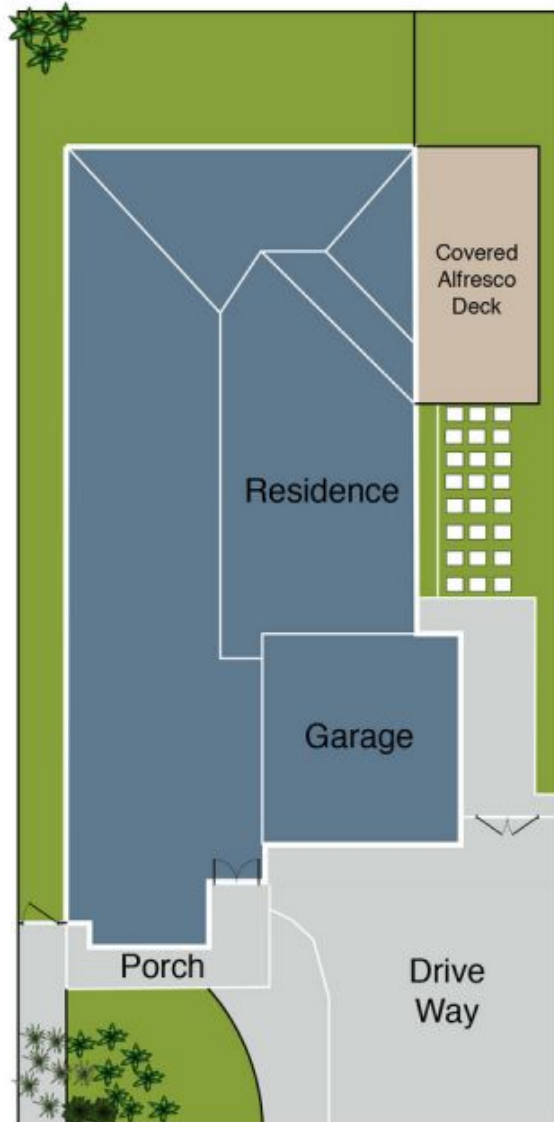

42 Pegasus Road, Cranbourne West

*Dimensions are approximate and for illustration purposes only

