



20 Kismet Road Sunbury VIC

5 🛏 2 🚿 5 🚗

Welcome home to a truly special offering in the prestigious and tightly held Kismet Estate.

This home is more than a property - it's an opportunity to secure your own private lifestyle with a 4,276m² (approx. 1 acre / flat) allotment which is flexible for any usage. Space, elegance and convenience all come together here, creating the perfect place for family living and entertaining in one of Sunbury's most sought-after locations.

Step inside the home and be greeted by warmth, light and generous proportions. This beautifully designed residence features:

? Four spacious bedrooms, including a master suite with walk-in robe and full ensuite PLUS additional study and retreat spaces which can become fifth and sixth bedrooms if required.

? A modern kitchen with stone benchtops, new Smeg rangehood, dishwasher, and abundant storage, flowing

Land Size : 4276 sqm

View : <https://www.ypa.com.au/8488568>



Lisa Totaro
0410 144 215



Cassandra Doria
0497 972 028

20 Kismet Road, SUNBURY

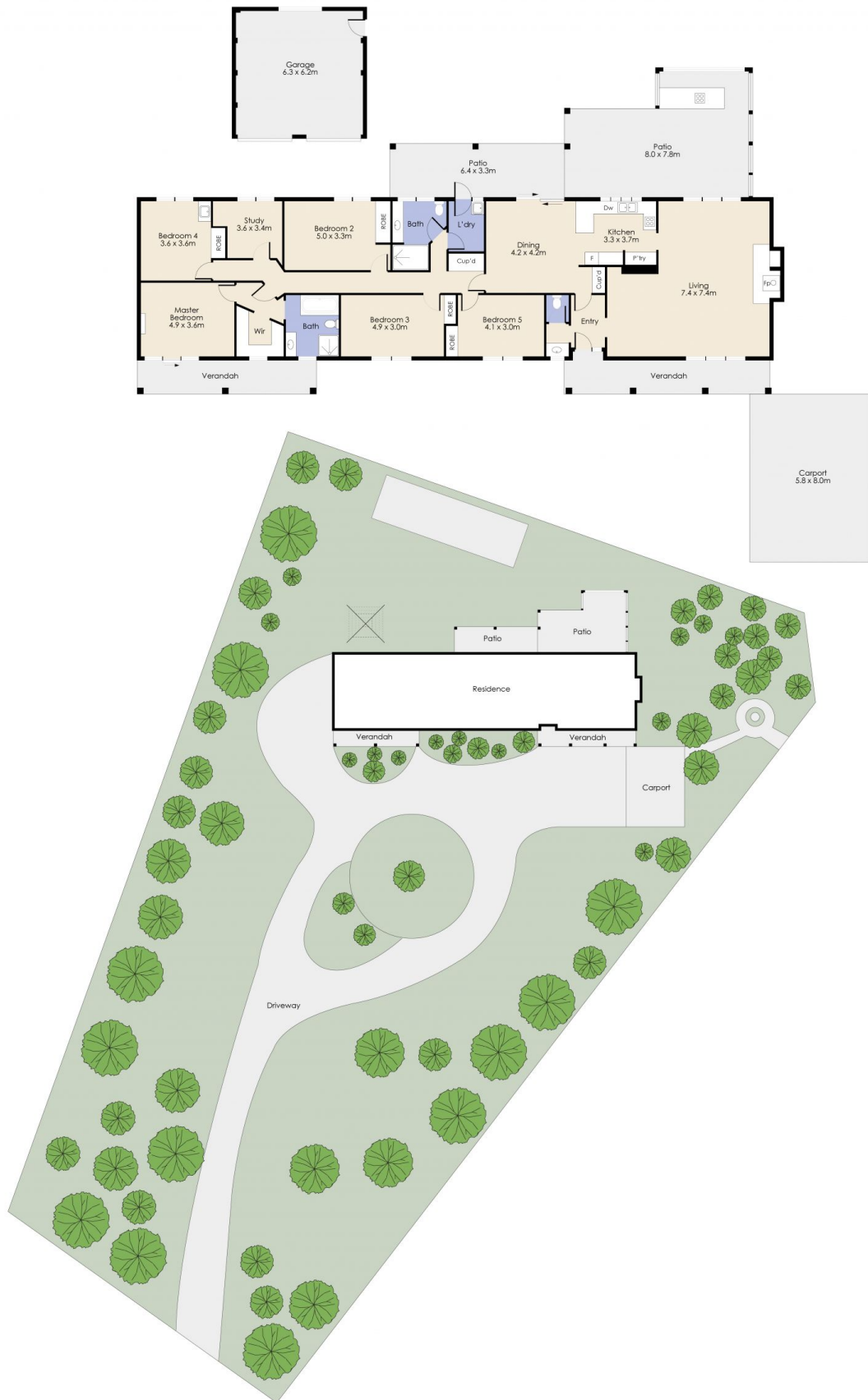

Whilst every attempt has been made to ensure the accuracy of the floor plan contained here, measurements of doors, windows, rooms and any other item are approximate and no responsibility is taken for any error, omission, or misstatement. This plan is for illustrative purposes only and should be used as such by any prospective purchaser. The services, systems and appliances shown have not been tested and no guarantee as to their operability or efficiency can be given.