



## 13 Frankland Court Wyndham Vale VIC

3 2 4

This well presented and generously proportioned home is located in a quiet, family-friendly court and offers the perfect balance of space, functionality, comfort and only located a short distance to Presidents Park.

**Land Size** : 700 sqm  
**View** : <https://www.ypa.com.au/8480822>

With multiple living zones, quality updates throughout, and an enormous outdoor entertaining area, this home is ideal for families or professionals seeking a relaxed lifestyle in a convenient location.

### Key Features Include

- Three Spacious Bedrooms
- ? Master bedroom with dual built-in robes and private ensuite
- ? Bedrooms 2 and 3 also feature built-in robes



**Victoria Galea**  
**0401 609 553**

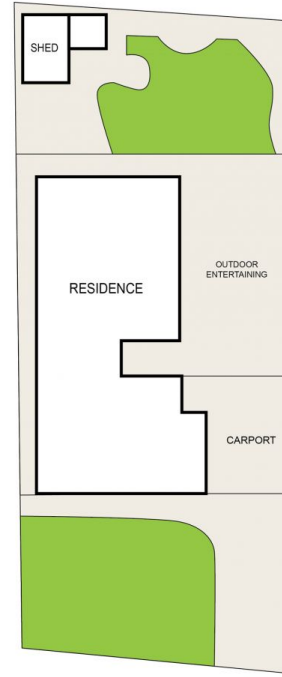

SITE PLAN  
(NOT TO SCALE)



## 13 Frankland Court, Wyndham Vale

DISCLAIMER : ALL DIMENSIONS ARE AN APPROXIMATION ONLY AND NO GUARANTEE IS GIVEN WITH RESPECT TO ACCURACY.