



3 Otway Green Caroline Springs VIC

4 🏠 2 🚗 2 🚗

Perfectly positioned in one of Caroline Springs' most sought-after pockets, right beside the tranquil Parkway Reserve playground, this magnificent family home combines space, functionality and lifestyle on an impressive 640m² (approx.) allotment. Designed with the growing family in mind, this beautifully presented home offers multiple living zones, a flexible floorplan and an inviting indoor-outdoor flow - ticking every box for comfortable, stylish living. With public transport, picturesque parklands, quality schools, and Caroline Springs Town Centre just moments away, this location truly has it all.

Price : \$ 930,000
Land Size : 640 sqm
View : <https://www.ypa.com.au/8475392>

Property Highlights:

- ? Generous master suite with walk-in robe and private ensuite
- ? Three additional spacious bedrooms (one without built-in



Andrew Migliorisi
0432 526 844



Stephen Azzopardi
0402 012 554

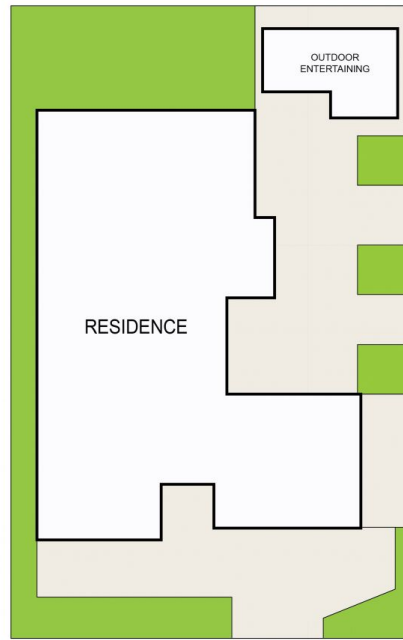

SITE PLAN
(NOT TO SCALE)



3 Otway Green, Caroline Springs

DISCLAIMER : ALL DIMENSIONS ARE AN APPROXIMATION ONLY AND NO GUARANTEE IS GIVEN WITH RESPECT TO ACCURACY.