



## 10 Mircella Place Melton West VIC

3 2 4

This beautifully presented family home is truly one of a kind. Situated in arguably one of the best and most convenient pockets of all of Melton West, this home is not one to miss out on. With parklands, public transport, Woodgrove Shopping Centre, freeway access, multiple schools and so much more at literally your doorstep, while also still sitting on a massive 791m<sup>2</sup> (approx.) block, this spacious home could be the perfect one for you.

As you arrive towards the home, you are immediately taken back by the home's lovely presence in the court. Surrounded by the most amazing neighbours, you are greeted with a neat façade, a huge low maintenance front yard, and the perfect land size for all your family needs.

Stepping through the front door, you'll immediately notice the generously sized first living area on the left-hand side,

**Price** : \$ 632,000  
**Land Size** : 791 sqm  
**View** : <https://www.ypa.com.au/8472903>



**Junior MuBashar**  
0450 644 606

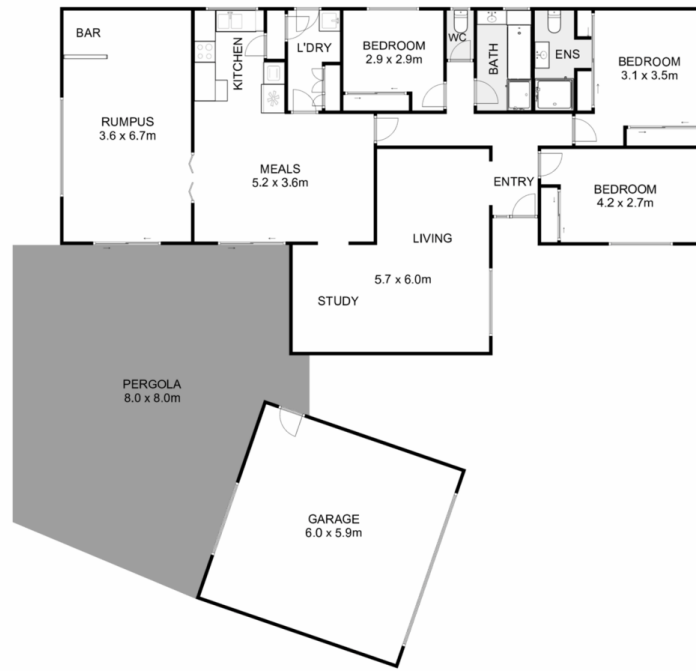

## 10 Mircella Place, Melton West



Whilst every attempt has been made to ensure the accuracy of the floor plan contained here, measurements of doors, windows, rooms and any other items are approximate and no responsibility is taken for any error, omission, or mis-statement. This plan is for illustrative purposes only and should be used as such by any prospective purchaser. The services, systems and appliances shown have not been tested and no guarantee as to their operability or efficiency can be given.

