



## 6 Parkdale Drive LYNDHURST VIC

3 2 2

Discover the perfect home for your family in the welcoming community of Lyndhurst. This charming three-bedroom, two-bathroom house offers a cozy and functional layout, ideal for families looking for comfortable living without breaking the bank. With secure parking and air conditioning, this property ensures convenience and comfort for all seasons.

Lyndhurst is known for its family-friendly environment, complete with parks, schools, and local amenities that cater to everyday needs. Enjoy the convenience of nearby shopping centers and easy access to public transport, making commutes a breeze. The suburb's community spirit and tranquil surroundings provide a peaceful retreat from the hustle and bustle of city life.

Don't miss this rare opportunity to secure an affordable

**Land Size** : 380 sqm  
**View** : <https://www.ypa.com.au/8468960>



**Pulkit Khetarpal**  
0413 500 090



**Hemant Dobriyal**  
0424 938 441

## Floor Plan



## Site Plan

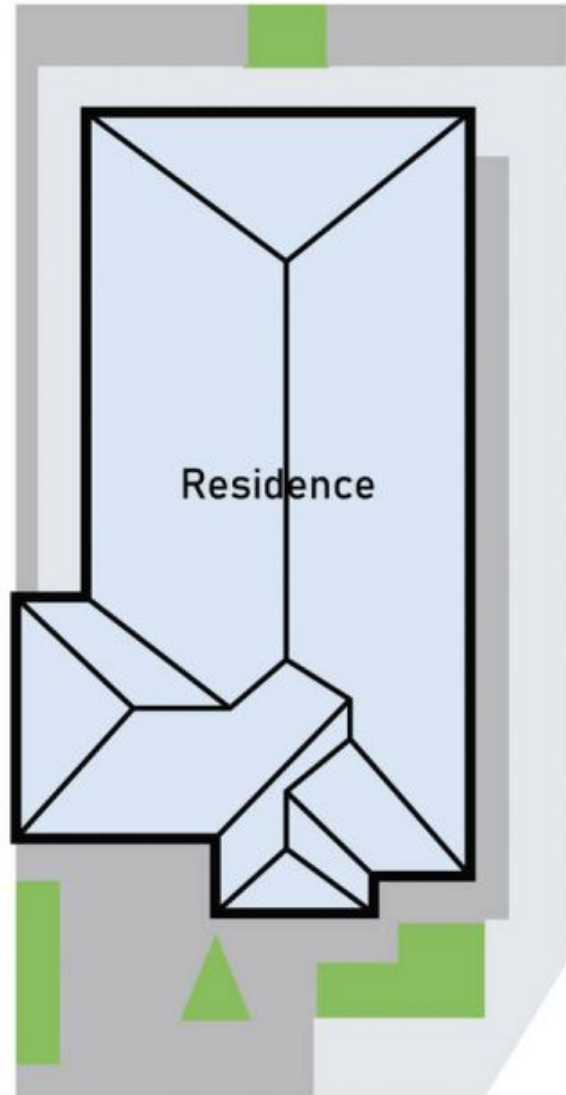

## 6 Parkdale Drive Lyndhurst

\* Dimensions are approximate and for illustrative purposes only