



## 11 Hannah Close Melton West VIC

4 2 2

This beautiful home is situated on a 717m<sup>2</sup> (approx.) allotment in the heart of Melton West just moments away from all amenities, including public transport, schools of all levels including Wedge Park Primary School, Melton Secondary College, Saint Catherine of Sienna Primary School and Saint Francis College. While it also sits in close proximity to Woodgrove Shopping Centre, milk bar, parklands, walking tracks, easy freeway access and Melton Waves Leisure Centre.

Upon entry you will find the three bedrooms that this property has to offer, all generously sized and boasting built in robes, while the master bedroom features a split system, walk in robe and a tastefully updated ensuite boasting stone benchtops, floating vanity, matte black tapware and floor to ceiling porcelain tiles. The bedrooms are all complimented by the upgraded central bathroom

**Price** : \$ 635,000

**View** : <https://www.ypa.com.au/8467424>



**Shane Spiteri**  
0488 980 115



**Tahlia Hall**  
0422 419 589

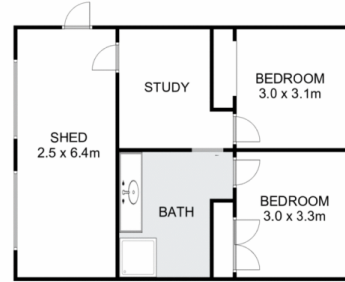

# 11 Hannah Close, Melton West



Whilst every attempt has been made to ensure the accuracy of the floor plan contained here, measurements of doors, windows, rooms and any other items are approximate and no responsibility is taken for any error, omission, or mis-statement. This plan is for illustrative purposes only and should be used as such by any prospective purchaser. The services, systems and appliances shown have not been tested and no guarantee as to their operability or efficiency can be given.

