



58 Valley Drive Rye VIC

5 2 4

Set in a sought-after pocket of Rye, 58 Valley Drive presents a rare and exciting chance to secure two properties on the one title - the ultimate blend of lifestyle and investment.

The front residence is available with vacant possession - ready to be moved into, leased out, or stylishly updated to maximise its potential and features three spacious bedrooms, a central bathroom, two versatile living zones, a large kitchen and dining area, and a private courtyard ideal for outdoor entertaining.

To the rear, a second two bedroom, one bathroom dwelling provides immediate income security with a lease in place until June 2026. This dual dwelling setup creates an exceptional opportunity for investors, multi-generational living, or those looking to live in one and earn passive

Price : \$ 835,000
Land Size : 694 sqm
View : <https://www.ypa.com.au/8460105>



Tony Talarico
0420 778 401



Sharnara Ryan
0457 186 833



Residence 1 area
approx: 11 squares

Residence 2 area
approx: 6 squares

Carport area
approx: 4 squares

Total area
approx: 21 squares

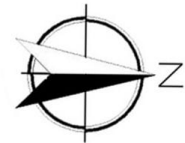

RESIDENCE 2

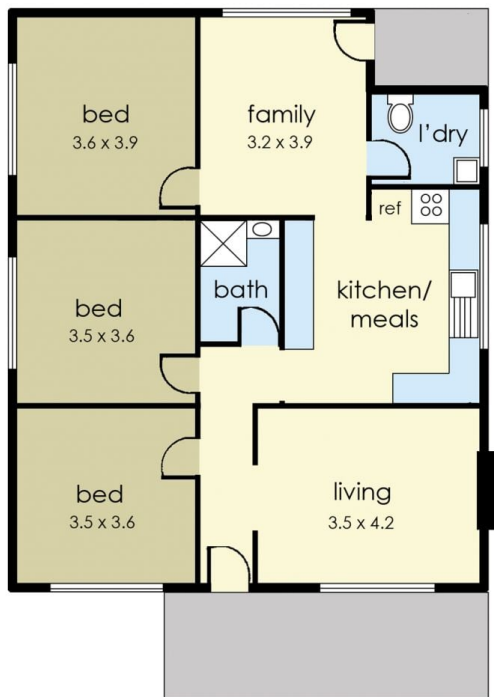

RESIDENCE 1

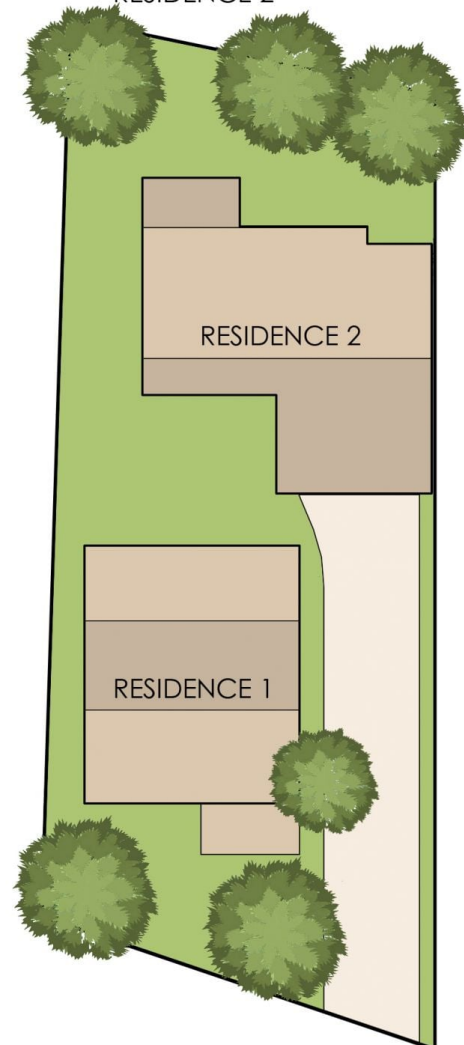

58 Valley Drive, Rye

The floor plan is provided for general information and illustrative purposes only. All measurements, dimensions, and layouts are approximate and may vary from the actual property. While every effort has been made to ensure accuracy, no responsibility is taken for any error, omission, or misstatement. Prospective buyers should not rely solely on the floor plan and are encouraged to conduct their own inspections and verify all details independently. The design and content of this floor plan remain the property of DND Floor Plans. ©