



2 Chiswick Officer VIC

5 4 2

Perfectly positioned on a generous corner block in the prestigious Timbertop Estate, this breathtaking residence at 2 Chiswick Street, Officer sets a new benchmark for modern family living. With elevated hilltop views and luxurious finishes throughout, this exceptional home combines sophisticated design, practical functionality, and a lifestyle of absolute comfort.

From the moment you step through the wide hallway entrance, you're welcomed into a home that exudes space, light, and style. The elegant interiors and well-considered layout create an inviting atmosphere for families of all sizes. Offering a flexible 4 oversized bedroom floorplan with option of a 5th downstairs bedroom and four

Price : \$ 1,150,000
Building Size : 362 sqm
Land Size : 512 sqm
View : <https://www.ypa.com.au/8458452>



Vikram Chandel
0430 055 933



Frances Cutri
0423 485 688

GROUND FLOOR



FIRST FLOOR



SITE PLAN

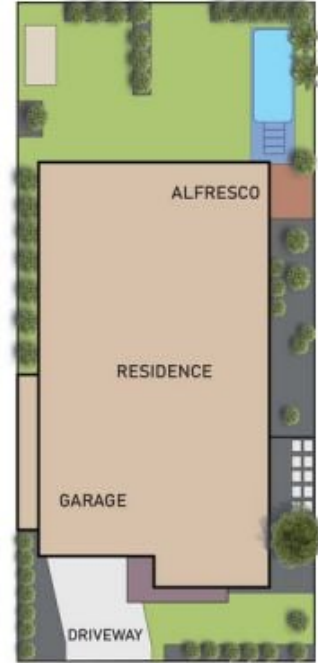

2 CHISWICK STREET, OFFICER



FLOOR AND SITE PLAN IS FOR ILLUSTRATIVE PURPOSES ONLY AND NOT TO SCALE. THE VENDOR, AGENCY OR SUPPLIER MAKE NO GUARANTEE, WARRANTY OR REPRESENTATION AS TO THE ACCURACY OF ANY INFORMATION CONTAINED HEREIN AND THE COMPLETENESS OF THE FLOOR PLANNED WILL ACCEPT NO LIABILITY FOR ITS ACCURACY. INTERESTED PARTIES ARE ADVISED TO MAKE THEIR OWN INDEPENDENT ENQUIRIES.

Produced by BLOOM MEDIA AGENCY