

*Outline indicative only



14 Buffalo Crescent Pacific Pines QLD

4 🚗 2 🚚 2 🚗

Nestled in a coveted position, this exceptional property proudly occupies an elevated quarter acre block, offering sweeping views of the surrounding area.

The residence features multiple living spaces seamlessly converging around the heart of the home—the well-appointed kitchen, complete with a convenient walk-in pantry. Natural breezes effortlessly traverse the property, ensuring a cool and comfortable ambiance, particularly during the sizzling summer months. The motivated sellers invite written offers from interested buyers as they embark on their relocation journey.

Resort-Style Living with Sweeping Views

To elevate the property's allure, the current owners have transformed the front of the block into a resort-style haven,

Price : \$ 1,295,000
Land Size : 1064 sqm
View : <https://www.ypa.com.au/8451138>



Steven Spiteri
0423 428 079



Sebastian Powell
0402 556 125

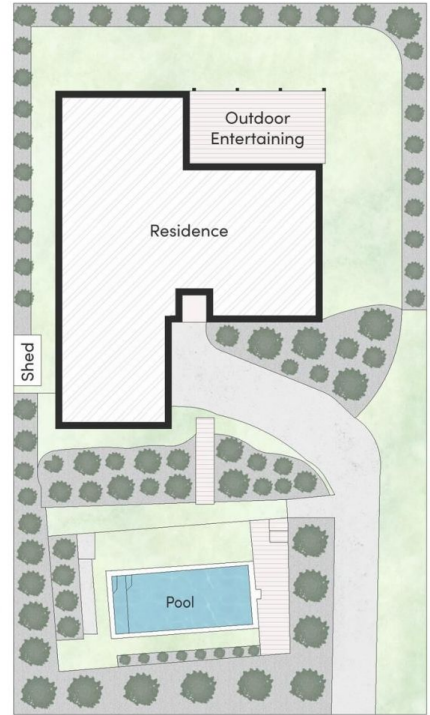

14 Buffalo Crescent, PACIFIC PINES

4 2 2

INTERNAL: 184m² | EXTERNAL: 35m² | TOTAL: 219m² | LAND SIZE: 1064m²

ARTIST'S IMPRESSION ONLY: While every attempt has been made to ensure the accuracy of this floor plan's areas and measurements of doors, windows, rooms and all other items are approximate and no responsibility is taken for any error, omission, or mis-statement. This plan is for illustrative purposes only and should only be used as such by any prospective purchaser.

