

7 Ellypark Crescent Clyde North VIC

4  2  2 

Nestled in the sought-after Moremac Smiths Park Estate, this near-new family home perfectly balances timeless elegance with modern practicality. Thoughtfully designed and finished to an exceptional standard, it offers a refined lifestyle across a versatile floorplan tailored to today's family living.

The residence opens with a welcoming formal lounge before flowing into a sunlit open-plan living and dining space. The designer kitchen features a generous walk-in pantry, expansive stone benchtops, premium appliances, and ample storage ? a true centrepiece for family gatherings.

The master suite is a private retreat with a spacious walk-in robe and sleek ensuite. Two further bedrooms also feature walk-in robes, while a fourth bedroom provides flexibility for

Price : \$ 740,000

View : <https://www.ypa.com.au/8450837>



Kamaljeet Singh
0433 619 387



Vijay Kumar
0431 177 566

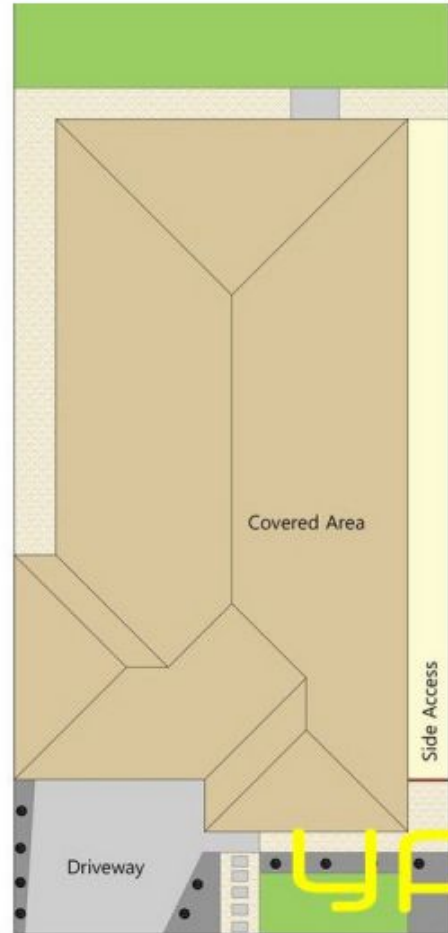

ypa

Every care has been taken to verify the accuracy of the details in this brochure, however we cannot guarantee its correctness. Prospective purchasers are requested to take such action as is necessary to satisfy themselves of any pertinent matters.