



1 Reef Ct Aspendale Gardens VIC

4 3 2

Positioned opposite peaceful parklands, this double-storey home offers generous space and modern comforts for the whole family. Featuring 4 well-sized bedrooms and 3 bathrooms, there's plenty of room for everyone.

Enjoy energy savings with solar panels, and stay cosy in winter with underfloor heating. Light-filled living areas provide a welcoming atmosphere, perfect for relaxing or entertaining.

Located just a short stroll to Aspendale Gardens Primary School and close to shops, parks and public transport, this home ticks all the boxes for family convenience.

Be quick - book your inspection today and secure this exceptional lease opportunity!

View : <https://www.ypa.com.au/8441854>



Carla Primiano
0407 183 331

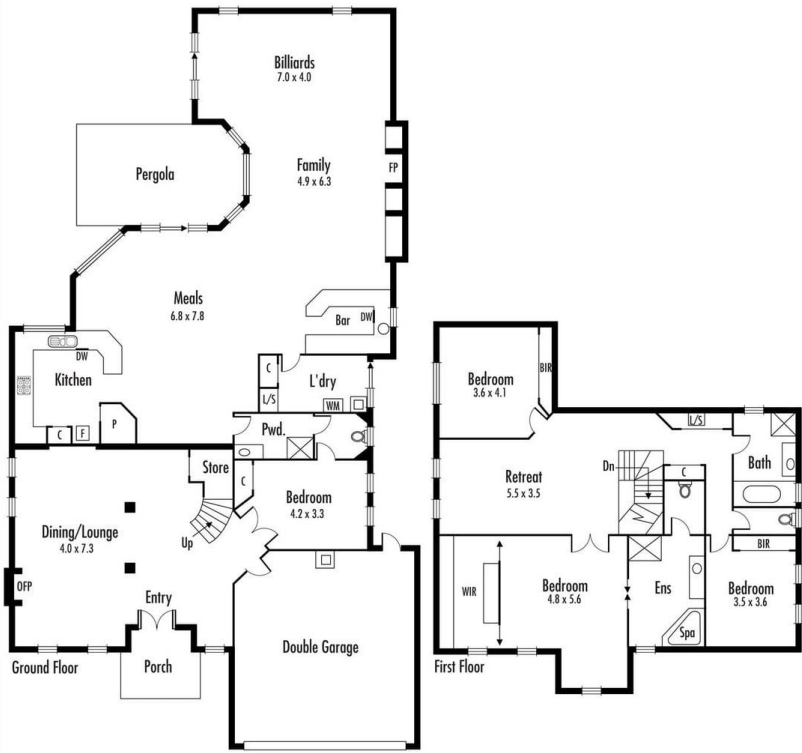

Whilst every attempt has been made to ensure the accuracy of the floor plan contained here, measurements of doors, windows, rooms and any other items are approximate and no responsibility is taken for any error, omission, or mis-statement. This plan is for illustrative purposes only and should be used as such by any prospective purchaser. The services, systems and appliances shown have not been tested and no guarantee as to their operability or efficiency can be given.