



39 Felecia Street Rye VIC

3 1 3

Set on a generous level allotment measuring approximately 880sqm and located just a 15 minute walk from the breath taking coastline of 16 beach, this beautifully presented property offers a peaceful lifestyle like no other. Welcome to your perfect coastal escape.

Surrounded by nature and offering thoughtfully landscaped gardens, this magical property includes a dedicated children's play area, veggie patch, lush green lawns, and a striking 60 year old Canadian maple tree that adds a beautiful layer of charm and shaded protection from the hot summer sun.

The home has been tastefully updated throughout and is move-in ready, featuring a newly renovated kitchen with stone benchtops and all-new Bosch appliances, as well as a stylishly updated laundry and bathroom with matching

Price : \$ 990,000
Land Size : 880 sqm
View : <https://www.ypa.com.au/8420570>



Jade Springer
0437 410 791



Kelsie Janssen
0417245204



Internal living area
approx: 13 squares

Carport area
approx: 2 squares

Verandah area
approx: 5 squares

Total area
approx: 20 squares

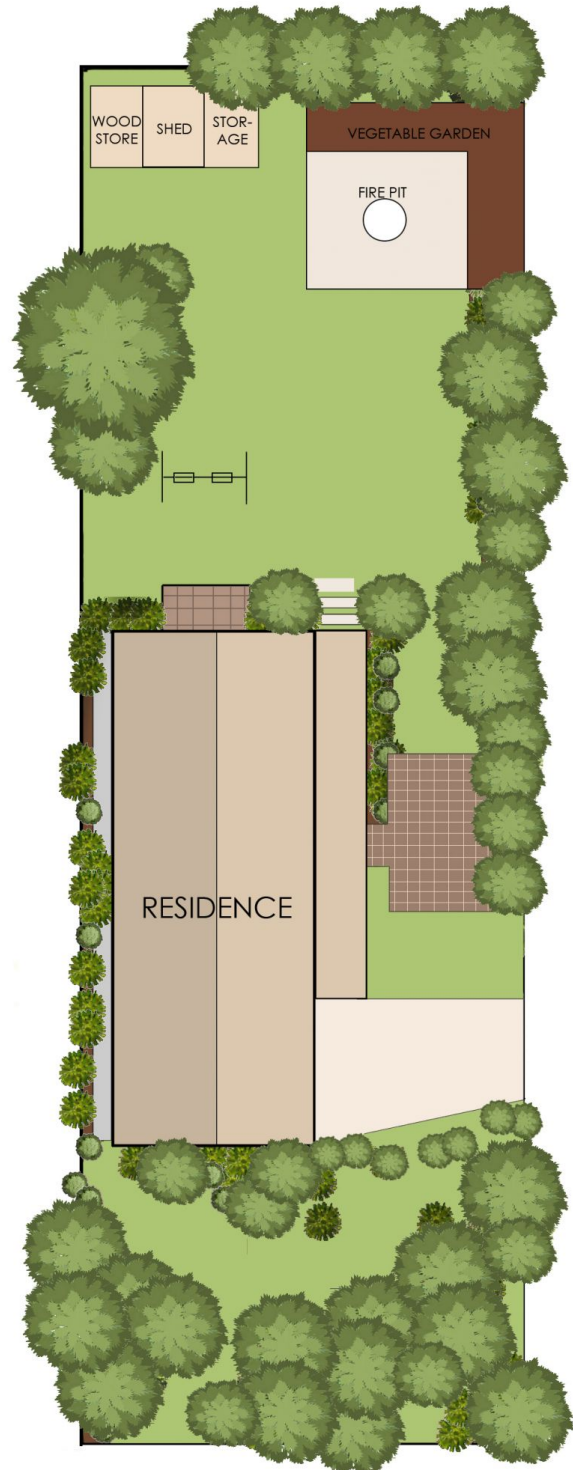
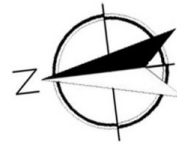

39 Felecia Street, Rye

© Produced by DND Floor Plans