

## 19 River Park Court Werribee VIC

3  2  2 

Perfectly positioned in a prime location overlooking the picturesque Werribee River, this immaculately presented double-storey residence has been extensively updated in recent years and offers stylish, move-in-ready living with room for the whole family.

Step inside to discover a thoughtfully designed layout featuring multiple spacious living zones. The ground floor boasts a large formal lounge and dining area, a versatile study with internal access to the double garage (including rear roller door), and a generous master bedroom complete with walk-in robe and private ensuite.

The renovated, fully equipped kitchen takes centre stage in the open-plan meals and family zone, offering seamless flow to the beautifully landscaped, low-maintenance backyard and outdoor entertaining area-perfect for

**Price** : \$ 950,000  
**Land Size** : 758 sqm  
**View** : <https://www.ypa.com.au/8416740>



**Danish Natha**  
0405 857 895



**James Antonio**  
0401 889 248

# 19 River Park Court, WERRIBEE

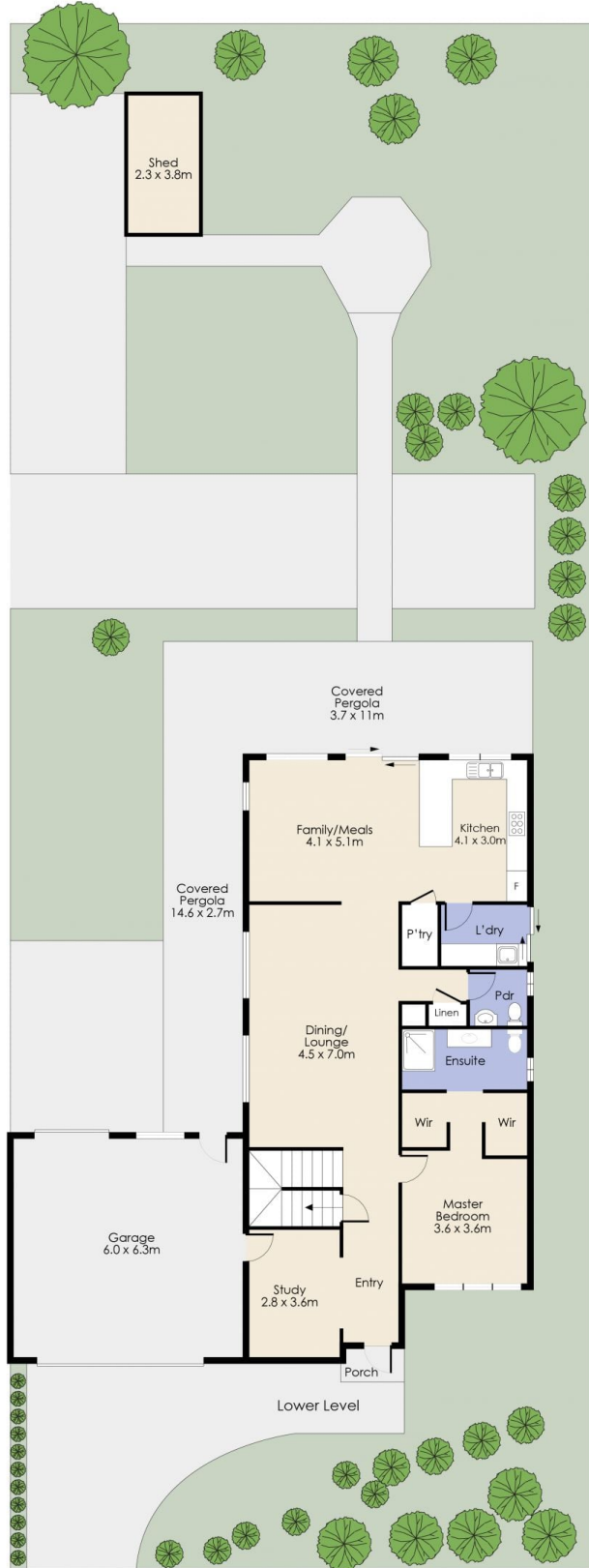

Ground Floor



Upper Level

Whilst every attempt has been made to ensure the accuracy of the floor plan contained here, measurements of doors, windows, rooms and any other item are approximate and no responsibility is taken for any error, omission, or mis-tatement. This plan is for illustrative purposes only and should be used as such by any prospective purchaser. The services, systems and appliances shown have not been tested and no guarantee as to their operability or efficiency can be given.