



### 3 Fortitude Ave Beveridge VIC

3  2  1 

Stylish, Low-Maintenance Living in Sought-After Mandalay Estate

**Price** : \$ 437,000

**View** : <https://www.ypa.com.au/8350503>

Perfectly positioned in the heart of the close-knit Mandalay Estate community, this stylish and low-maintenance home offers an ideal lifestyle opportunity for first-home buyers, downsizers, young families, or savvy investors.

Designed with modern comfort in mind, the home features a spacious open-plan living and dining area with easy-care tiled flooring, seamlessly flowing into a well-appointed kitchen complete with stainless steel electric oven, gas cooktop, and dishwasher. Sliding doors open to a paved outdoor patio, perfect for entertaining or soaking up the sun in the low-maintenance garden surrounds.

Three carpeted bedrooms include built-in robes, with the



**Manu Kumar**  
0435 456 004



**Charlotte Motley**  
0418 294 339

### Floor Plan

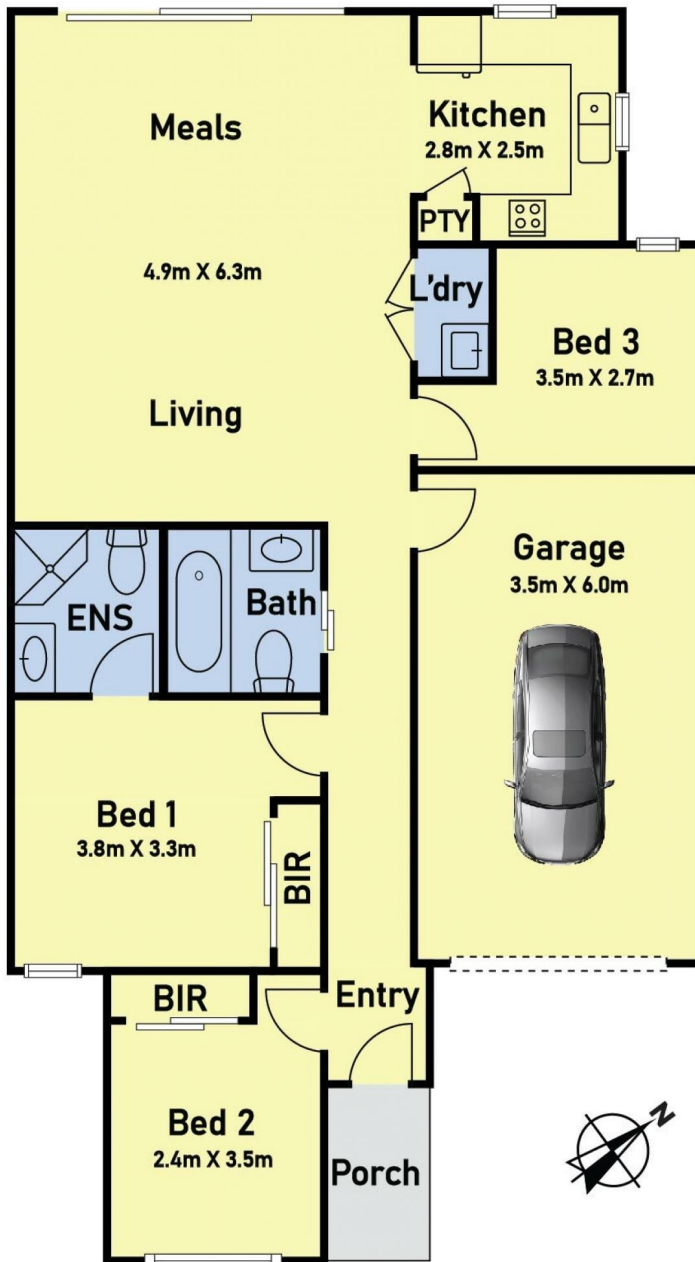
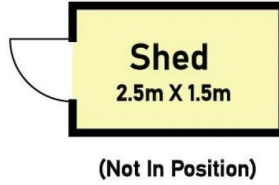

NOTE: SIZE AND DIMENSIONS ARE INDICATIVE AND SHOULD NOT BE TAKEN AS DEFINITE.