

20 Blaxland Avenue CRANBOURNE NORTH VIC

3  **1**  **1** 

This cozy and bright home, consisting of 3 bedrooms and 1 bathroom, is the ideal property for anyone looking for a new place to call home. With its location being within close proximity to many amenities like that of a medical centre, Merinda Park Train Station, Saint Therese's Primary school, and more, this home is perfect and makes going far for necessities a thing of the past!

The features of the home include:

- ? Open-place kitchen and dining space.
- ? Generous lounge area.
- ? 3 bedrooms, with one being a master bedroom with a large walk-in robe.
- ? 1 bathroom.
- ? 1 car space.
- ? Neat-looking outdoor area.

Building Size : 112 sqm
Land Size : 403 sqm
View : <https://www.ypa.com.au/8293417>



Jayne Rosevear
0438 580 780



Pulkit Khetarpal
0413 500 090

Floor Plan



Site Plan

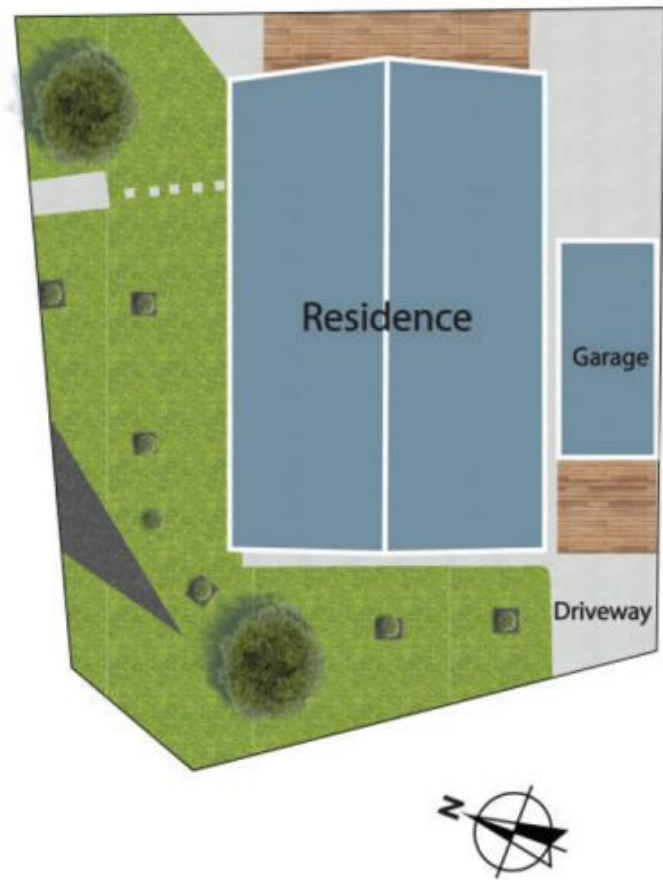

20 Blaxland Avenue, Cranbourne North, Vic 3977

* Dimensions are approximate and for illustrative purposes only