

13 Mossfiel Drive Hoppers Crossing VIC

4 2 2

Nestled in the heart of Hoppers Crossing, 13 Mossfiel Drive is a home that radiates warmth, quality, and timeless appeal. Thoughtfully designed with generous proportions and an abundance of natural light, this meticulously crafted double-story residence is the perfect blend of character and functionality, offering an exceptional opportunity for families, professionals, and astute buyers.

From the moment you step inside, the stunning polished floorboards, slate tiling, and granite bench tops create a striking first impression, showcasing the craftsmanship and enduring quality that define this home. Expansive windows invite natural light to pour into every room, highlighting the spacious and versatile layout designed for effortless family living.

With four oversized bedrooms, this home ensures every

Price : \$ 660,000
Land Size : 558 sqm
View : <https://www.ypa.com.au/8288848>



Abdul Merabi
0424 263 506



Ibrahim Ahmed
0449 119 577

13 Mossfiel Drive, HOPPERS CROSSING

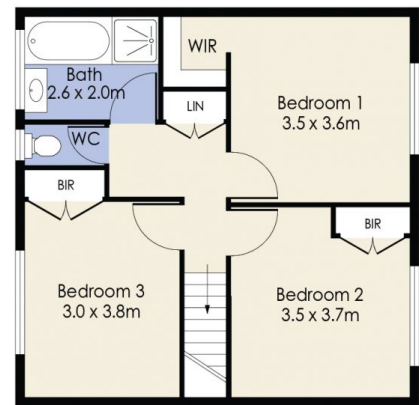

Whilst every attempt has been made to ensure the accuracy of the floor plan contained here, measurements of doors, windows, rooms and any other items are approximate and no responsibility is taken for any error, omission, or mis-statement. This plan is for illustrative purposes only and should be used as such by any prospective purchaser. The services, systems and appliances shown have not been tested and no guarantee as to their operability or efficiency can be given.