

25 Valley Drive Rye VIC

3 2 2

Perfectly positioned on a huge 1,313m² allotment in a private, elevated setting, 25 Valley Drive, Rye, is a charming coastal haven that blends modern comfort with timeless appeal. Constructed from bespoke reclaimed bricks on a solid concrete foundation, this thoughtfully designed three-bedroom, two-bathroom home offers a warm and inviting atmosphere, ideal for families and entertainers alike.

Step inside to discover a stylishly updated kitchen, where an induction cooktop and stainless steel appliances elevate both functionality and aesthetic appeal. The adjoining dining and living area provides a seamless flow, complemented by a cosy wood-burning fire, ceiling fans, and split-system heating and cooling for year-round comfort.

Price : \$ 1,170,000
Land Size : 1313 sqm
View : <https://www.ypa.com.au/8249025>



Tony Talarico
0420 778 401



Katrina Talarico
0420 778 404

Internal living area
approx: 18 squares

Pergola area
approx: 7 squares

Total area
approx: 25 squares

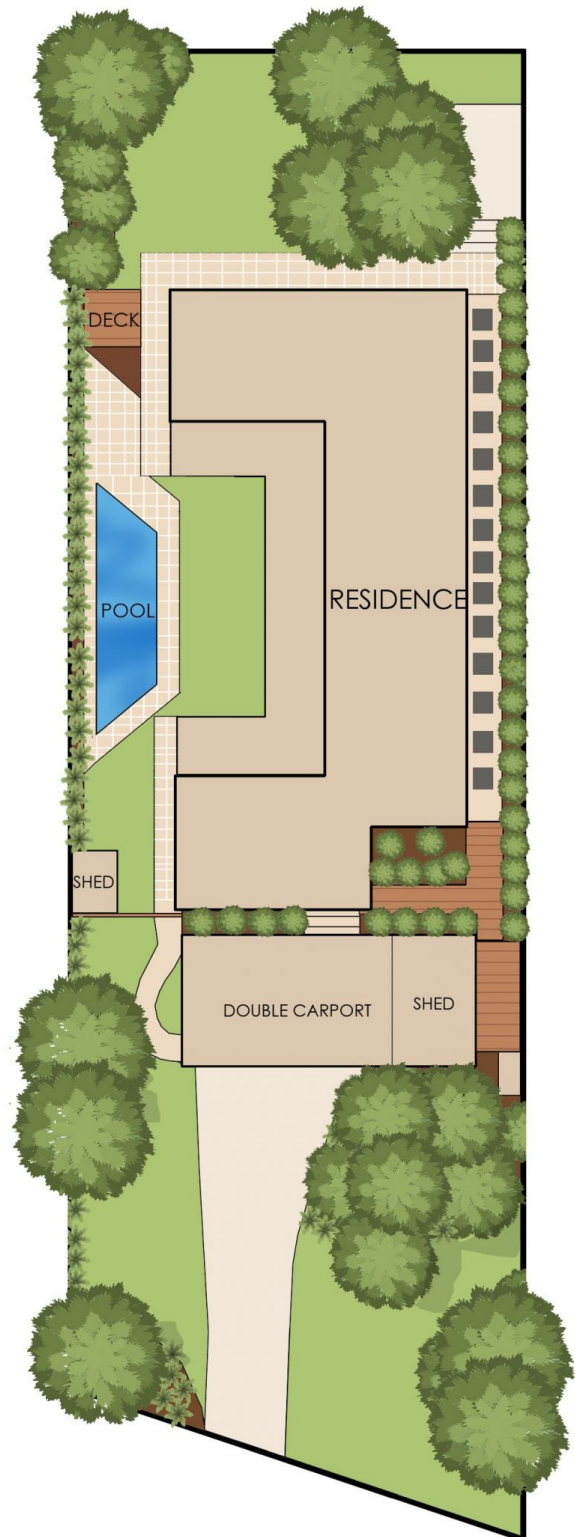
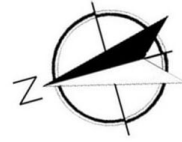

25 Valley Drive, Rye

© Produced by DND Floor Plans

This floorplan is for illustration purposes only and no warranty is given to its accuracy. Purchasers are advised to carry out their own investigations.