

101 Gisborne-Melton Road Kurunjang VIC

5 🛏 3 🚿 2 🚗

Sitting in the sought after suburb of Kurunjang this property sits within close proximity to everything Kurunjang has to offer. Whether it be parks and walking tracks, milk bars, frisbee golf course and Melton Golf Course, or even Kurunjang Primary and Secondary School, everything is at your fingertips.

Price : \$ 630,000
Land Size : 662 sqm
View : <https://www.ypa.com.au/8246985>

As you enter the property you are greeted with a large formal living area, featuring timeless features such as timber trimmings, wool carpets and feature light fixtures. The space also features a gas wall heater and split system providing total weather control all year round. The ground floor also features two great sized bedrooms that are perfect for the growing family or family members who prefer to be downstairs, these are both serviced by the downstairs central bathroom for added convenience.



Shane Spiteri
0488 980 115



Ricky Frew
0402 007 100

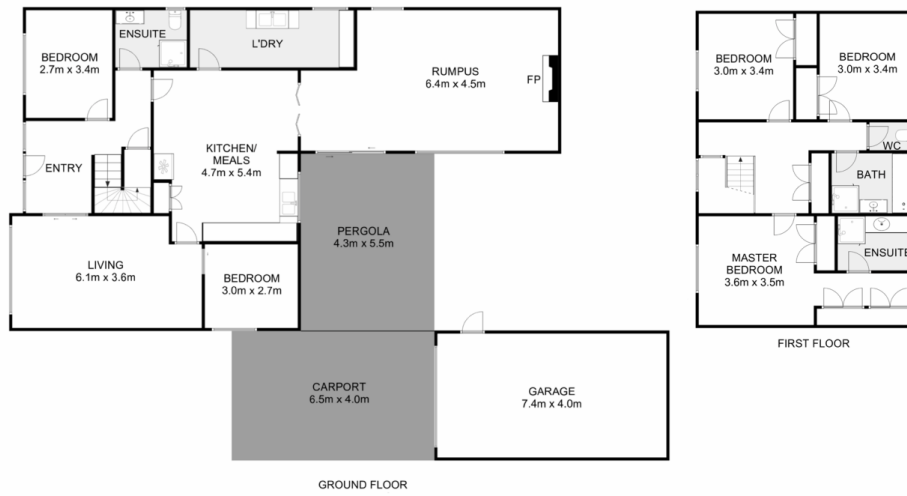

101 Gisborne-Melton Road, Kurunjang

Ypa

Whilst every attempt has been made to ensure the accuracy of the floor plan contained here, measurements of doors, windows, rooms and any other items are approximate and no responsibility is taken for any error, omission, or mis-statement. This plan is for illustrative purposes only and should be used as such by any prospective purchaser. The services, systems and appliances shown have not been tested and no guarantee as to their operability or efficiency can be given.

