



## 12 Mossfield Mews Tullamarine VIC

4 3 2

This spacious and well-designed 4-bedroom home offers a fantastic opportunity for families, investors, or those looking to add their own personal touch. including three separate living areas and three bathrooms, this home provides plenty of space for comfortable living.

**Price** : \$ 730,000  
**Land Size** : 505 sqm  
**View** : <https://www.ypa.com.au/8244223>

As you step inside, you're welcomed by a formal living and dining area, perfect for entertaining guests or enjoying family meals. The heart of the home features a large timber kitchen with ample storage and bench space, seamlessly flowing into the meals area. Adjacent to this, a spacious family room opens out to a covered outdoor entertaining area, ideal for year-round gatherings. The lower level also accommodates three well-sized bedrooms, including a master suite with a walk-in robe and private ensuite. A central bathroom and a separate laundry complete the downstairs layout.



**Ali Faour**  
0432 273 353



**Gianni D'Angelo**  
0466 185 825

### First Floor

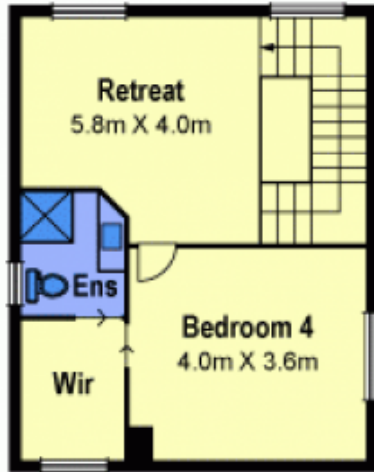

### Site Plan

