



## 25 Stirling Drive Derrimut VIC

3 2 2

Nestled in the highly desirable Derrimut suburb, this impeccably maintained property exudes perfection. Ideally located, it is close to local primary and secondary schools, Derrimut shopping centre, public transport, and offers easy access to the Western Highway. The surrounding scenic walking tracks enhance the convenience and natural beauty of the area, making it a prime location for families and individuals alike.

Presented by YPA Caroline Springs, this residence seamlessly merging practicality with comfort. The careful attention to detail stands as evidence of the thorough care and devotion invested in the property. Situated in a prestigious community, the home is not just a residence but a haven, promising a superior living experience by blending modest conveniences with an atmosphere of tranquillity.

**Price** : \$ 650,000  
**Land Size** : 461 sqm  
**View** : <https://www.ypa.com.au/8224550>



**Stephen Azzopardi**  
0402 012 554



**Andrew Migliorisi**  
0432 526 844

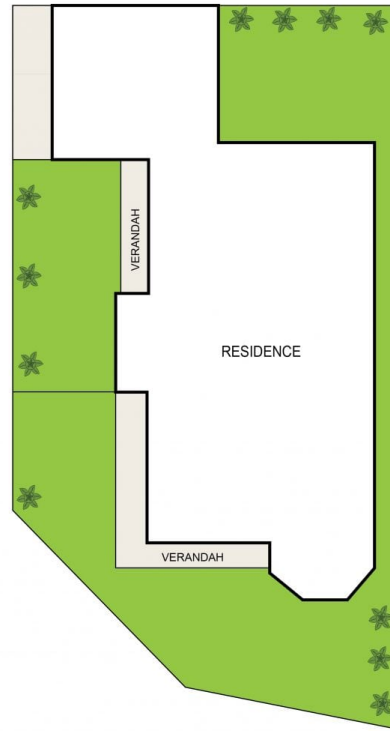

## 25 Stirling Drive, Derrimut

DISCLAIMER : ALL DIMENSIONS ARE AN APPROXIMATION ONLY AND NO GUARANTEE IS GIVEN WITH RESPECT TO ACCURACY.