



22 Bramshaw Crescent Hillside VIC

5 2 2

Situated on land of 800m² in a prized location. This Beautiful Family Home features unique extra-spacious living areas and high ceilings throughout. On entering the wide hallway, it leads you through to a flowing floor plan of multiple living and entertaining areas.

The home is centrally located within a short 5 mins drive to Watergardens Shopping Centre & railway station, plus private & public schools. Convenient to shops, daycare centre and parkland.

Comprises:

- ? 5 Bedrooms with BIR and master with full ensuite
- ? Extra-large formal lounge room with separate formal dining
- ? Large kitchen with quality finish and dining area
- ? Separate family/rumpus room for all day entertaining
- ? Tiled bathroom and separate laundry

Land Size : 800 sqm

View : <https://www.ypa.com.au/8219979>



Joe Albioli
0438 133 123



22 Bramshaw Crescent, Hillside, VIC, 3037

TOTAL APPROX. FLOOR AREA 281 SQ.M

Whilst every attempt has been made to ensure the accuracy of the floor plan contained here, measurements of doors, windows, rooms and any other items are approximate and no responsibility is taken for any error, omission, or misstatement. This plan is for illustrative purposes only and should be used as such by any prospective purchaser.

Photography and Floorplans by
VISUAL IMPRESSIONS

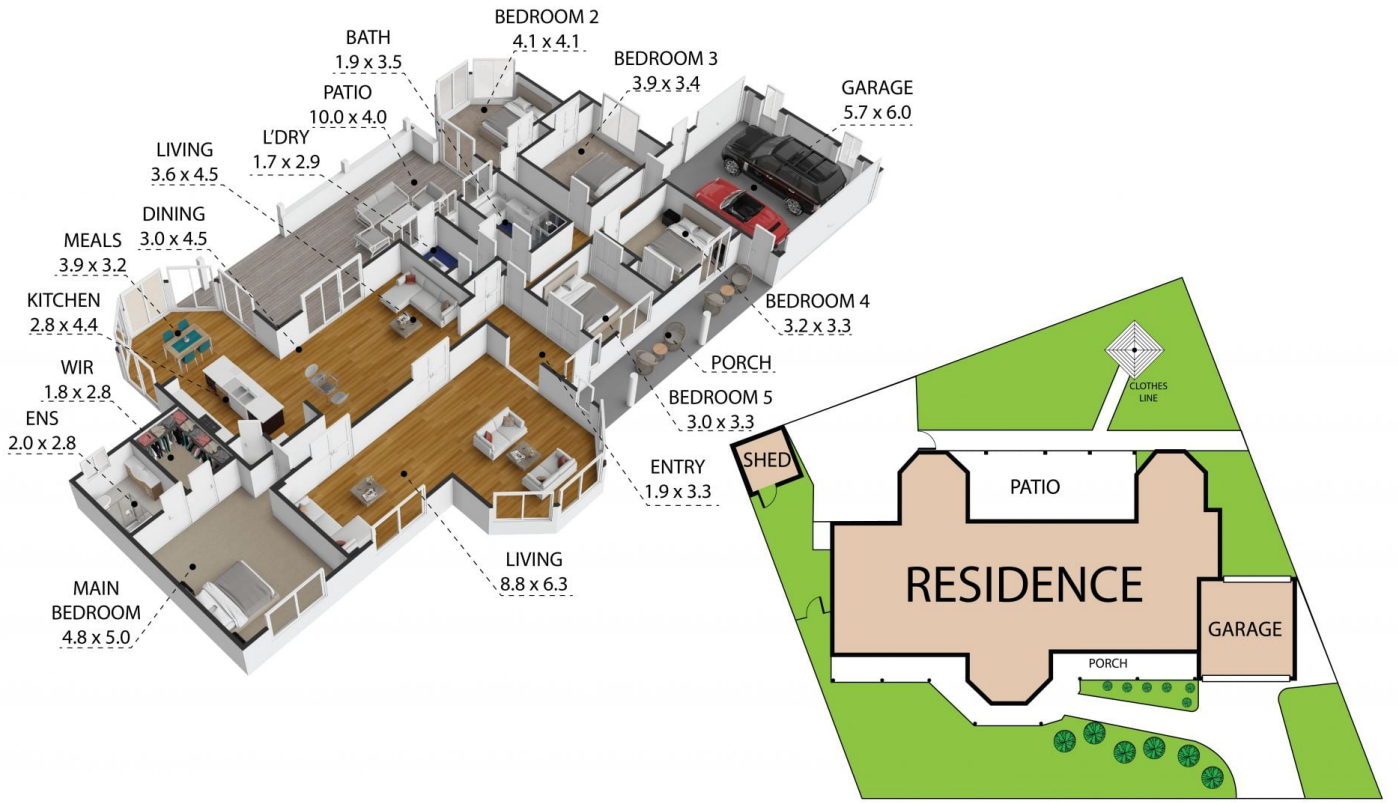

22 Bramshaw Crescent, Hillside, VIC, 3037

TOTAL APPROX. FLOOR AREA 281 SQ.M

Whilst every attempt has been made to ensure the accuracy of the floor plan contained here, measurements of doors, windows, rooms and any other items are approximate and no responsibility is taken for any error, omission, or misstatement. This plan is for illustrative purposes only and should be used as such by any prospective purchaser.

Photography and Floorplans by
VISUAL IMPRESSIONS