



ypa
in conjunction with
RAVECHE
PROPERTY GROUP



13C Morgan Street Rosebud VIC

3 2 2

Nestled just 500 metres from the golden sands of Rosebud Beach, 13C Morgan Street is a true coastal haven. Tucked away in a private and tranquil location, this beautifully maintained home offers a perfect blend of modern comfort and timeless charm. With a lush green alfresco entertaining, sunlit courtyards, and thoughtfully designed interiors, with high-end appliances, this home is an escape from the ordinary.

Step inside to discover a spacious open plan living and dining area, where natural light pours in, creating an inviting and airy atmosphere. The gourmet kitchen, complete with granite benchtops, high-quality Miele appliances, and a wall oven, is both a functional and stylish space for culinary enthusiasts.

Each of the three generously sized bedrooms exudes

Building Size : 161 sqm
Land Size : 542 sqm
View : <https://www.ypa.com.au/8219380>



Elke Remscheid
0423 211 315



Ryan Oswald
0402 720 822



Land: 542 m² approx.

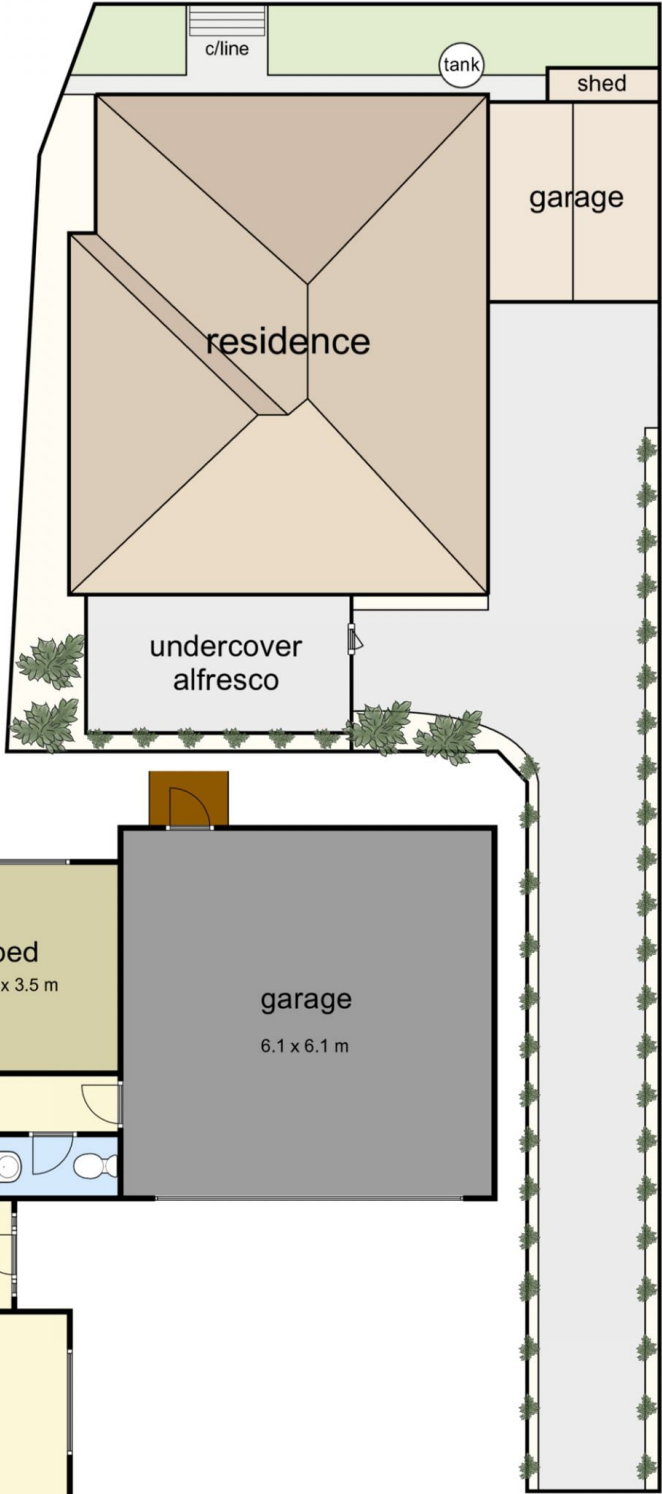

13c Morgan Street, ROSEBUD

Whilst every attempt has been made to ensure the accuracy of the floorplan contained here, measurements of doors, windows, rooms and any other items are approximate and no responsibility is taken for any error, omission or mis-statement. This plan is for illustrative purposes only and should be used as such by any prospective purchaser. The services, systems and appliances shown here are for illustrative purposes. Produced by Open2view.com