



## 33 Park Central Avenue Officer VIC

5 3 2

This exquisite family home, perfectly situated in the vibrant heart of Officer offers 5 spacious bedrooms, 3 modern bathrooms, and a double garage, this property offers a seamless blend of style, comfort, and functionality, making it an ideal choice for families or professionals.

Set on a generous 512sqm (approx) block directly across from picturesque parkland, the home provides ample space for outdoor living while embracing a serene natural setting. Step through the impressive double-door entry into a spacious front lounge, where a cozy gas log fireplace creates the perfect atmosphere for relaxation.

The light-filled kitchen and dining area are designed for entertaining, featuring a sleek waterfall-edge island bench, breakfast bar, walk-in pantry, and high-end appliances that cater to every culinary need. Upstairs, the master bedroom

**Price** : \$ 1,010,000  
**Building Size** : 270 sqm  
**Land Size** : 512 sqm  
**View** : <https://www.ypa.com.au/8211540>



**Vikram Chandel**  
0430 055 933



**Frances Cutri**  
0423 485 688

## Ground Floor

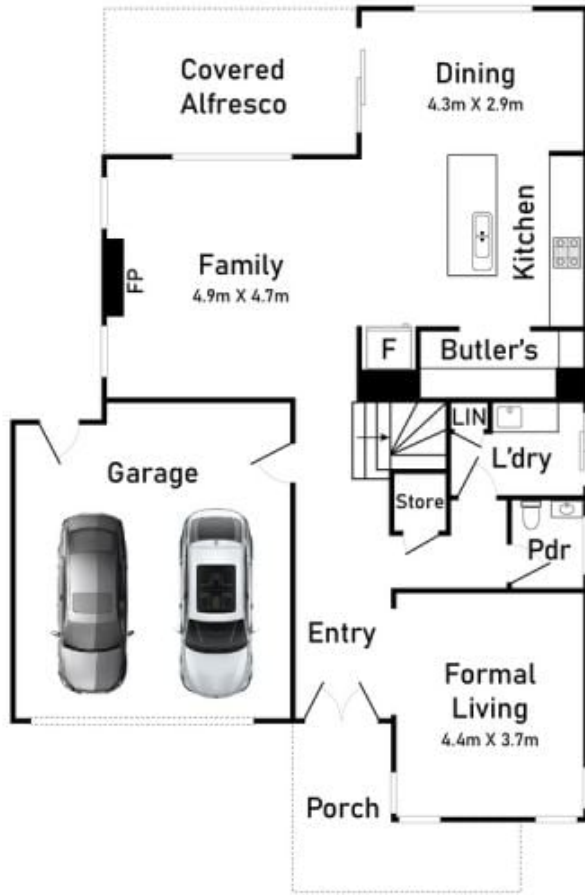

## First Floor

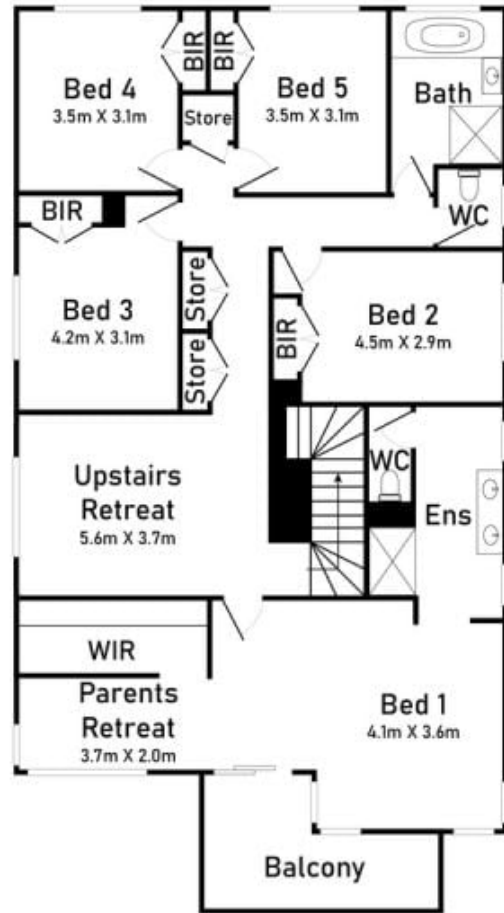

## 33 Park Central Avenue, Officer

\* Dimensions are approximate and for illustrative purposes only

