



12 Durham Place Sorrento VIC

5 3 2

Set beside the back beach dunes and the stunning Sorrento Back Beach & Ocean Beach, "Kimbrett" showcases traditional 1970s architectural lines with a charming earthy colour palette added with creature comfort modern amenities.

Situated on 898 sqm (approx.) of prime oceanside real estate, enjoy the soundtrack of the waves, the scent of the ocean breeze, rare privacy and serenity and boundless options to redevelop and create a superb new home or holiday retreat (STCA).

The main level features four bedrooms serviced by a family bathroom and separate laundry, with the master bedroom having the luxury of a walk-in robe and ensuite. A large, updated kitchen allows easy catering for the family. Two separate living areas allowing plenty of family space for

Land Size : 898 sqm
View : <https://www.ypa.com.au/8129967>



Elke Remscheid
0423 211 315

Internal area = 16.1 squares (approx)
 Deck area = 7 squares (approx)
 Garage area = 4.3 squares (approx)
 Total area = 27.4 squares (approx)

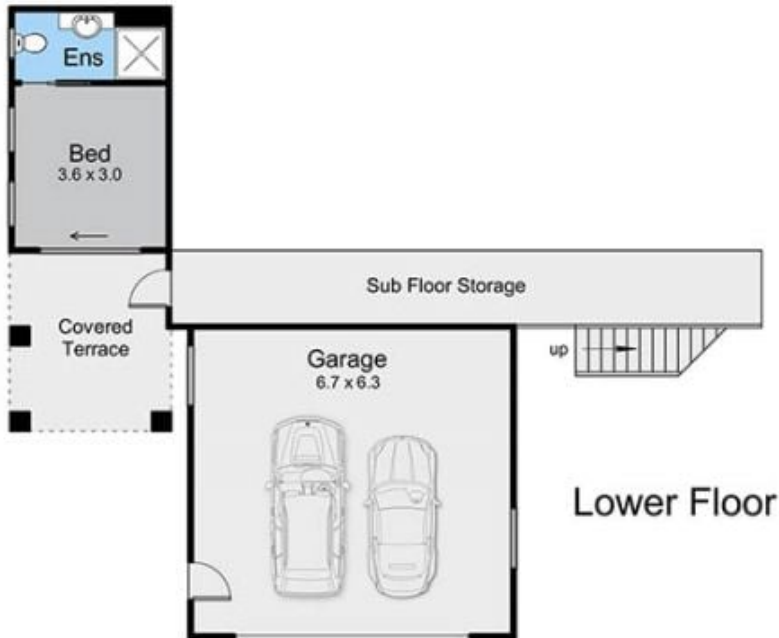
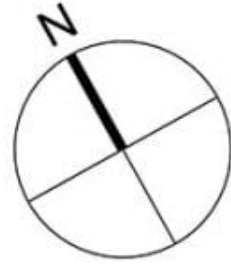

Land area = 897 sqm (approx)

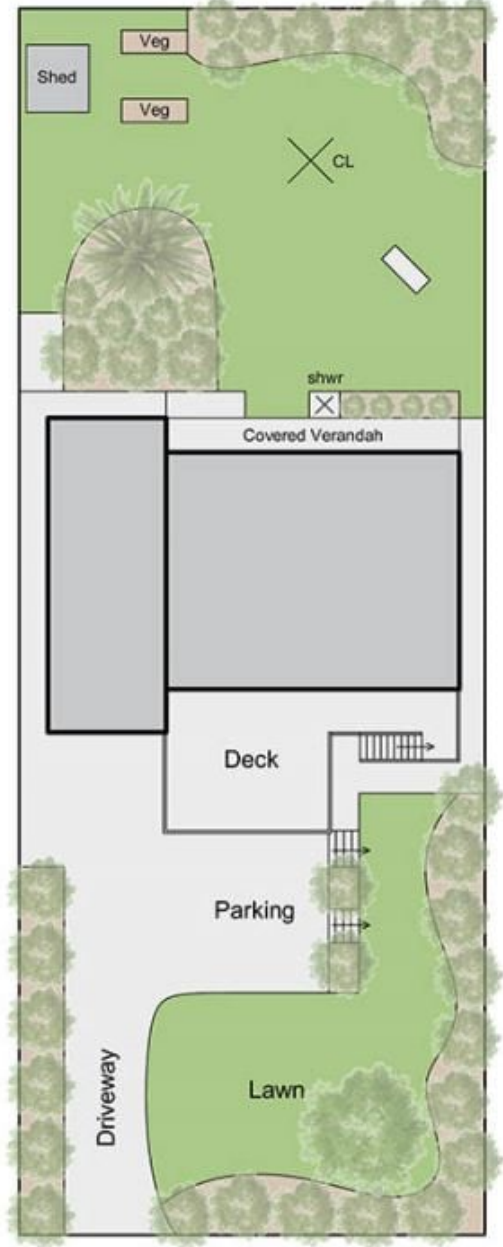

Site Plan

12 Durham Place, Sorrento

This floorplan is for illustration purposes only and no warranty is given to its accuracy. Purchasers are advised to carry out their own investigations. Produced by realtywriters (03) 5970 2222