



67-69 Glenvue Road Rye VIC

5 🏠 2 🚿 6 🚗

Discover an unparalleled opportunity to enjoy coastal living at its finest in this exquisite Southern Peninsula property located just moments to the crashing waves and pristine coastline of the Rye back beach.

Price : \$ 1,880,000
Land Size : 1996 sqm
View : <https://www.ypa.com.au/8120577>

Perfectly situated a short stroll from the stunning 16 Beach and the popular General Store, and only minutes from top-tier amenities like the Dunes Golf Course, Peninsula Hot Springs Day Spa, Moonah Links, and the vibrant St Andrews Brewery, Rye remains one of Australia's most coveted locations, this incredible five bedroom family home offers a lifestyle unlike any other!

Six-star energy rated, and set on a sprawling 1,996*m² allotment, the home enjoys a long list of premium features including a stunning 9x4m solar heated, saltwater pool (complete with in-floor cleaning), a gorgeous primary



Jade Springer
0437 410 791



Ben Nutbean
0413 125 996

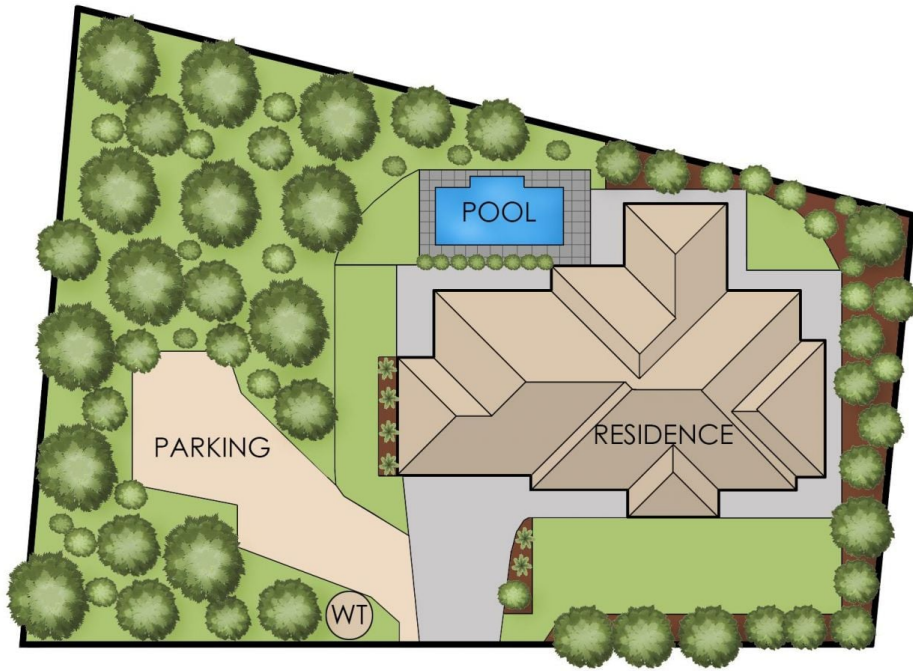

67-69 Glenvue Road, Rye

© Produced by DND Floor Plans

This floorplan is for illustration purposes only and no warranty is given to its accuracy. Purchasers are advised to carry out their own investigations.