

14 Eyre Street MELTON SOUTH VIC

3 2

Situated on a large 585m² (approx.), allotment and located in a quiet and convenient street, this property is sure to impress all buyers. Being within close proximity to parklands, shopping complexes, walking tracks, public transport, Melton Train Station, and zoned schools, this property offers not only a perfect family living environment but a wonderful area to enjoy all that the beautiful Melton community has to offer. The street is situated very close to St Anthony's Primary School and Melton South Primary School, only moments away from Staughton College and Al Iman college makes this the ideal home to raise a family or prime investment.

Price : \$ 525,000

View : <https://www.ypa.com.au/8008758>



Ryan Anders
0434 900 300

The manicured front garden is beautifully complimented by the rendered front fence creating secured car parking but also allowing the family to utilize the whole yard! The exterior of this home is also rendered uplifting the look of

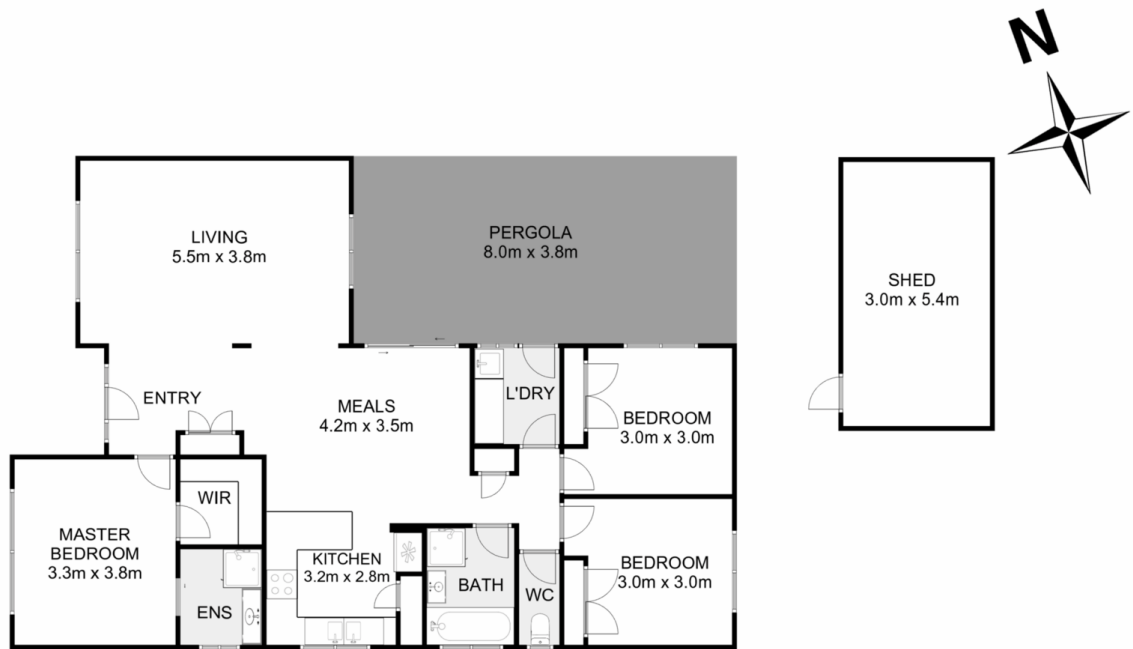

14 Eyre Street, Melton South

Ypa

Whilst every attempt has been made to ensure the accuracy of the floor plan contained here, measurements of doors, windows, rooms and any other items are approximate and no responsibility is taken for any error, omission, or mis-statement. This plan is for illustrative purposes only and should be used as such by any prospective purchaser. The services, systems and appliances shown have not been tested and no guarantee as to their operability or efficiency can be given.

