

3 Wattle Tree Drive Point Cook VIC

4 2 2

YPA Point Cook proudly presents 3 Wattle Tree Drive, Point Cook, a true embodiment of refined living and elegance. This exquisite home, meticulously crafted by Henley Homes, epitomizes luxury in every detail. Nestled in the prestigious Karinya Estate, this residence offers an expansive 646m² allotment, strategically positioned for seamless access to Point Cook's finest amenities including the Town Centre, Broadwalk Central Shopping Centre, Point Cook College, and Stella Maris Primary School.

Land Size : 646 sqm
View : <https://www.ypa.com.au/8000336>



Pardeep Chahal
0431 595 725



Manjot Bawa
0433 853 301

Drawing your attention from the moment you arrive, the captivating facade of this family haven is adorned with timeless architectural

Floor Plan

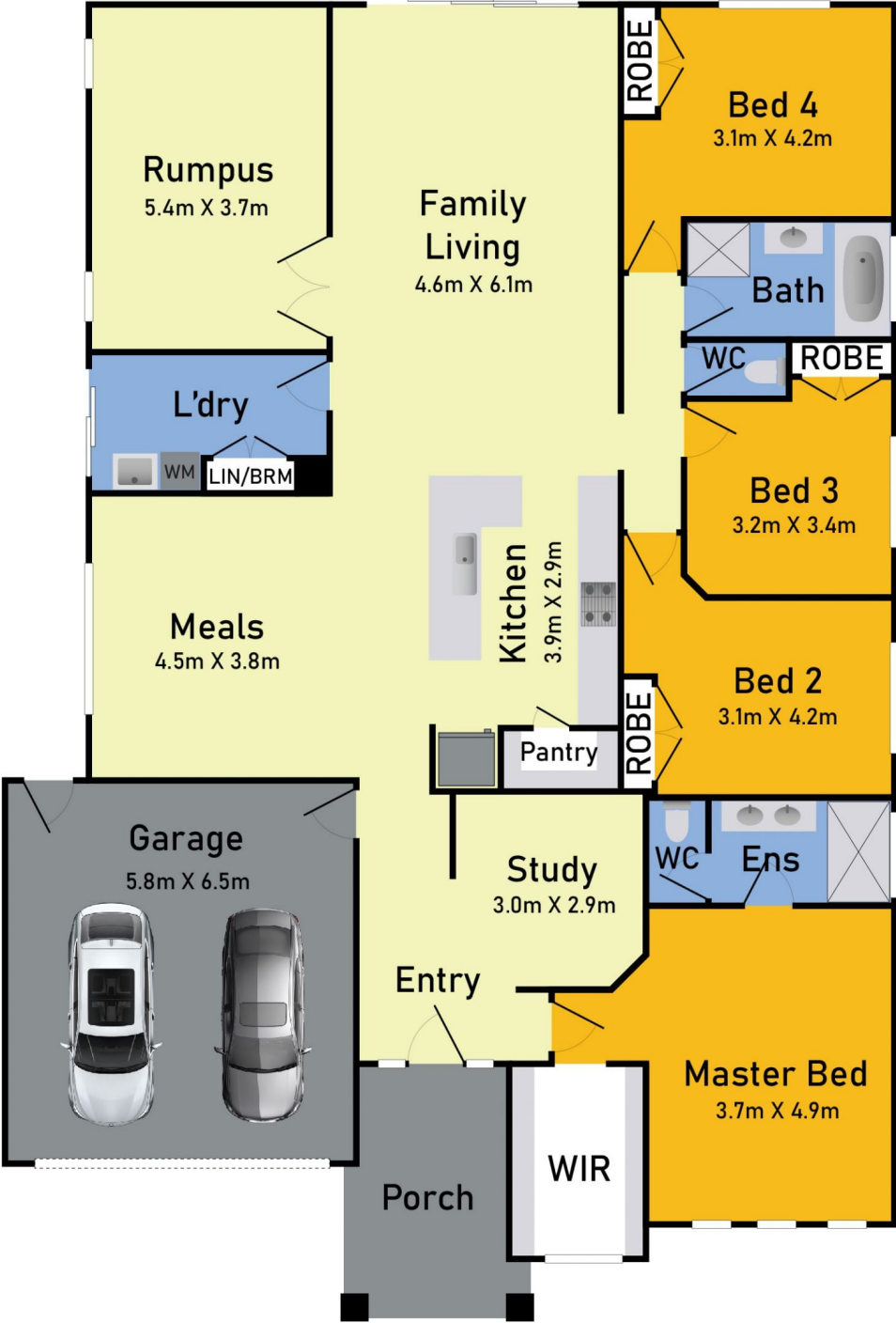

3 Wattle Tree Drive, Point Cook

* Dimensions are approximate and for illustrative purposes only