



32 Scarlet Drive Greenvale VIC

4 2 2

Looking to upsize, downsize or invest? 32 Scarlet Drive ticks all the boxes.

Step into the serene Greenvale Gardens Estate of Greenvale and discover the epitome of family living in this charming residence. Boasting single-level simplicity, low maintenance allure, and a sought-after corner block, this home invites you to create cherished memories. Conveniently located near bus stops, Greenvale Shopping Centre, and local schools, it's a haven waiting for your personal touch to truly make it your own.

Currently leased til 15th of November 2024 at \$500 per week.

Inside, you'll find a spacious master bedroom complete with a walk-in robe and ensuite, alongside three additional

Price : Private Sale | \$750,000
View : <https://www.ypa.com.au/7996798>



Alexander Sherriff
0438 212 714



Luke Albioli
0403 700 003

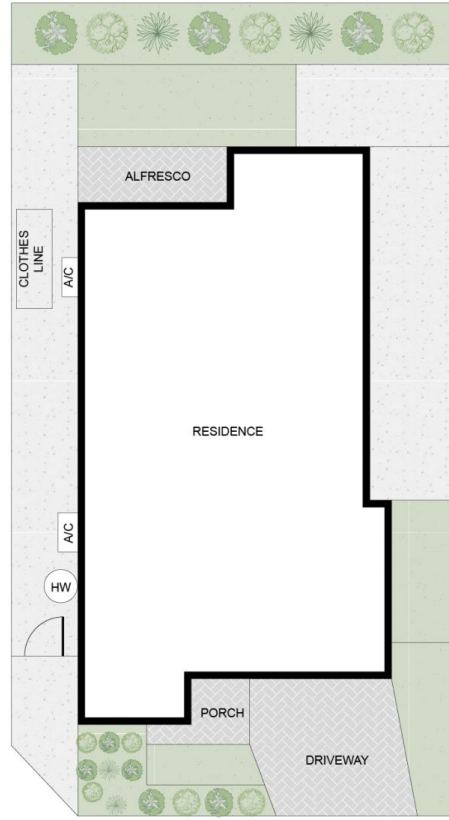

Scale in metres. Indicative only. Dimensions are approximate. All information contained herein is gathered from sources we believe to be reliable. However we cannot guarantee its accuracy and interested persons should rely on their own enquiries.