



3 Purcell Court Werribee VIC

4 2 2

Dressed in Deco charm and character, this alluring home presents a unique opportunity to secure the best in River front living that Werribee has to offer.

In a prestigious Werribee 'South Side' pocket adjacent to the Werribee River this magnificent home has seen a sensational modern upgrade with dramatic use of bold and texture that combine effortlessly with original design to create effortless living.

Featuring 4 bedrooms, master with WIR and ensuite, main bathroom, a sleek stone kitchen with luxury integrated appliances/gas cooking and spacious living/dining with separate family room and a fabulous outlook of the manicured low maintenance gardens. There is even a downstairs rumpus/ home cinema or teenagers retreat with its own internal/ external access.

Price : \$1,600,000
Land Size : 758 sqm
View : <https://www.ypa.com.au/7987962>



James Antonio
0401 889 248



Kirsty Cunningham
0414 344 475

3 Purcell Court, WERRIBEE

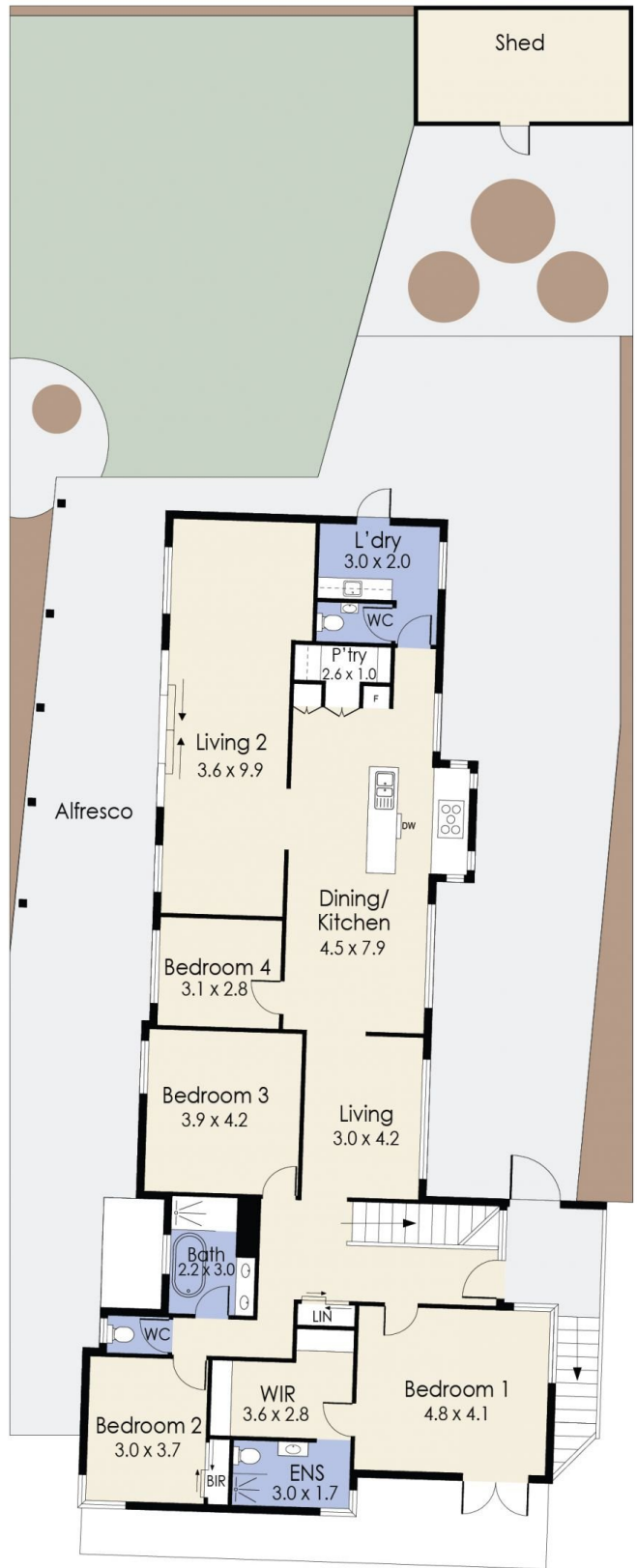
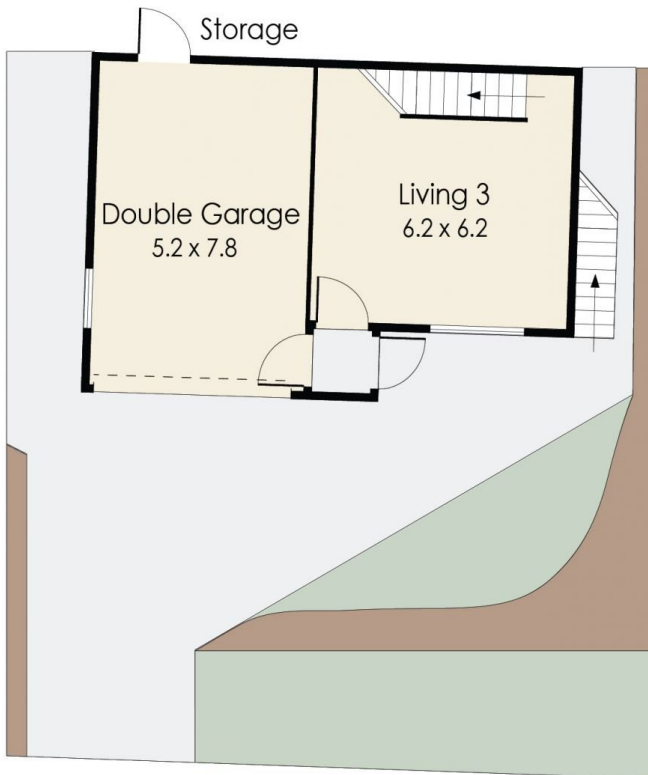
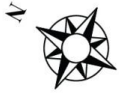

Whilst every attempt has been made to ensure the accuracy of the floor plan contained here, measurements of doors, windows, rooms and any other items are approximate and no responsibility is taken for any error, omission, or mis-statement. This plan is for illustrative purposes only and should be used as such by any prospective purchaser. The services, systems and appliances shown have not been tested and no guarantee as to their operability or efficiency can be given.