

12 Davison Court Maddingley VIC

3  2  2 

Ideal for an investment or first home, this modern day property offers exceptional value located in popular Maddingley. Comprising of three good size bedrooms all with built in robes and master with walk in robe and ensuite along with an open plan Kitchen, Meals and Family area makes this the perfect first home or even add another home to your portfolio.

Along with a double car garage with rear access, side access, landscape gardens set on an 871m2 approx. assures this property will not last long so call today to arrange an inspection.

(Photo ID is Required at all Open For Inspections)

At YPA Bacchus Marsh Our Service Will Move You

Price : \$ 560,000

Land Size : 871 sqm

View : <https://www.ypa.com.au/7986398>



Vickie Ramon
0403 194 621

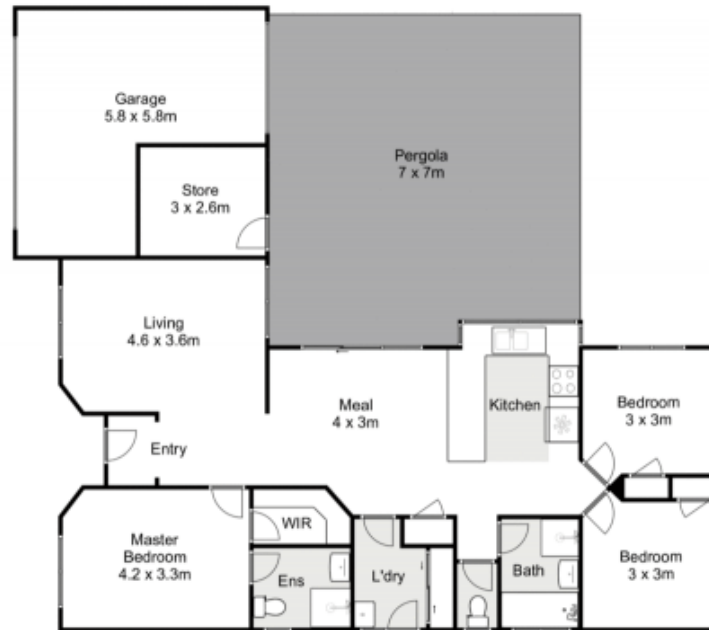

12 Davison Court, Maddingley



Whilst every attempt has been made to ensure the accuracy of the floor plan contained here, measurements of doors, windows, rooms and any other items are approximate and no responsibility is taken for any error, omission, or mis-statement. This plan is for illustrative purposes only and should be used as such by any prospective purchaser. The services, systems and appliances shown have not been tested and no guarantee as to their operability or efficiency can be given.

