



## 26 Inala Street Rye VIC

4 2 2

One of the coolest properties on the market, this fantastic four bedroom Rye Beach house - complete with its very own full size North-South facing tennis court - has been stylishly updated and offers the ultimate, quintessential coastal lifestyle in a quiet, sought after location.

Presenting homey, light filled interiors and beautiful tree top views, the internal floor plan of the home offers four good sized bedrooms (all with built-in robes), two bathrooms, full laundry room, and an open plan kitchen, dining, and living room complete with a cosy wood burning fire. The modern kitchen has been beautifully updated and includes gorgeous farmhouse cabinetry, a ceramic apron sink, stainless steel appliances, island bench, and glass pendant lighting.

**Price** : \$1,280,000 - \$1,380,000  
**Land Size** : 1828 sqm  
**View** : <https://www.ypa.com.au/7951012>



**Tony Talarico**  
0420 778 401



**Katrina Talarico**  
0420 778 404



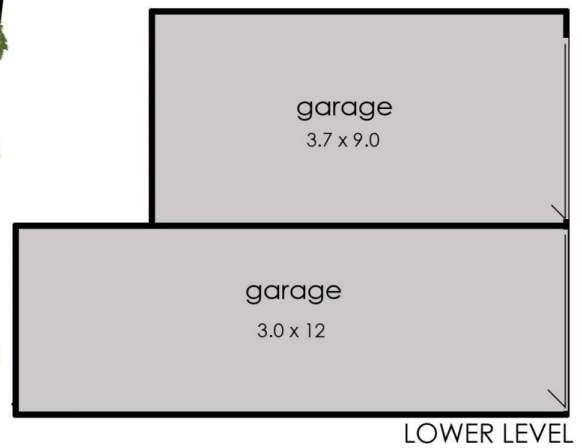
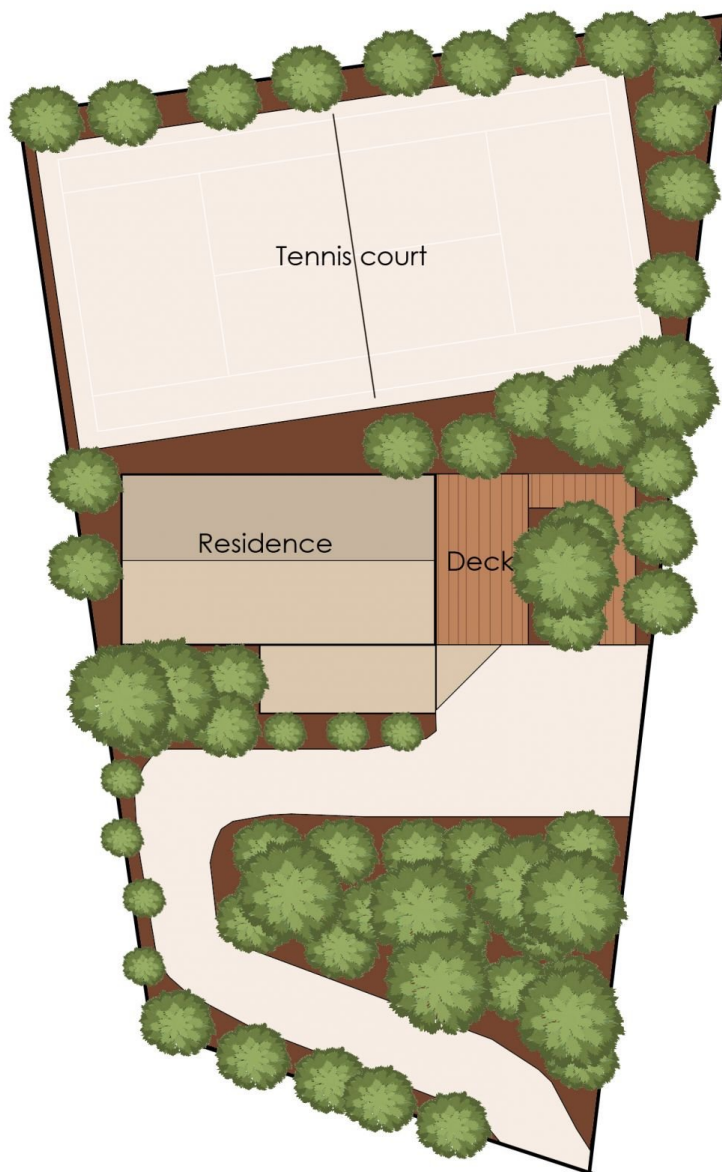
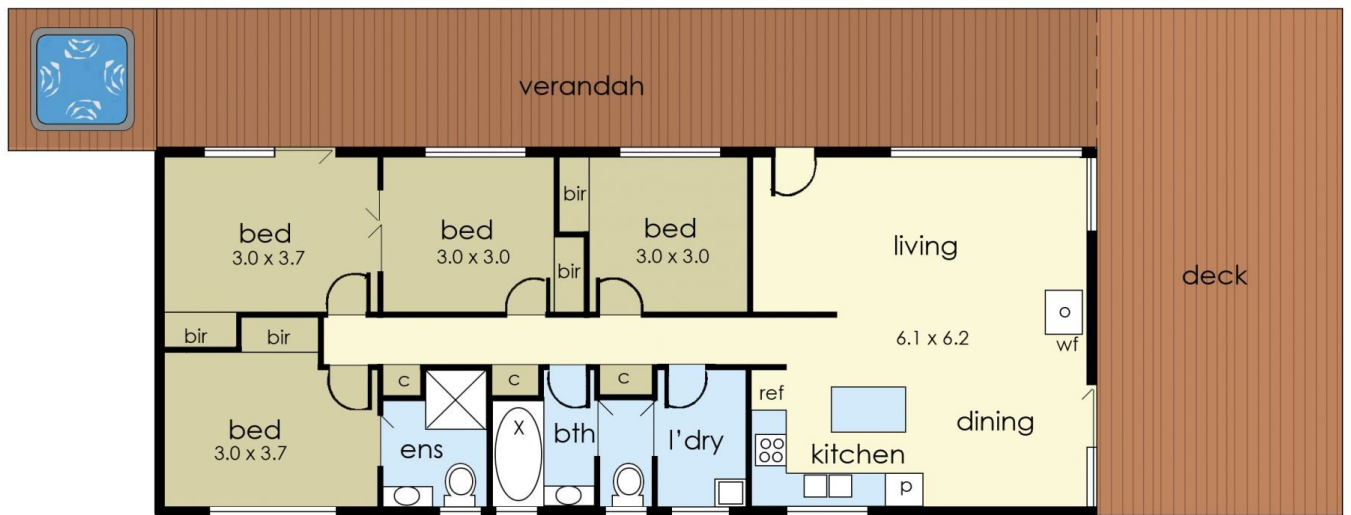

## 26 Inala Street, Rye

This floorplan is for illustration purposes only and no warranty is given to its accuracy. Purchasers are advised to carry out their own investigations.