



135 Canterbury Jetty Road Rye VIC

4 2 2

Stylishly renovated throughout and offering a long list of quality inclusions, this peaceful seaside home has been completely reimagined to reflect a modern coastal aesthetic where sophistication and relaxation combine in the most beautiful way.

The light filled interiors comprise three spacious bedrooms (including a sumptuous primary bedroom featuring ensuite and built in robe), modern family bathroom with custom floating vanity, frameless shower screen, and freestanding soaking tub, a full laundry room and separate toilet, a large open plan living and dining room, plus a luxury kitchen featuring custom cabinetry, waterfall stone island, stone countertops, and ILVE appliances.

The home additionally features a workshop, double carport, and an outdoor garden studio which could be utilised as a

Price : \$1,150,000 - \$1,220,000
Land Size : 875 sqm
View : <https://www.ypa.com.au/7940543>



Jade Springer
 0437 410 791

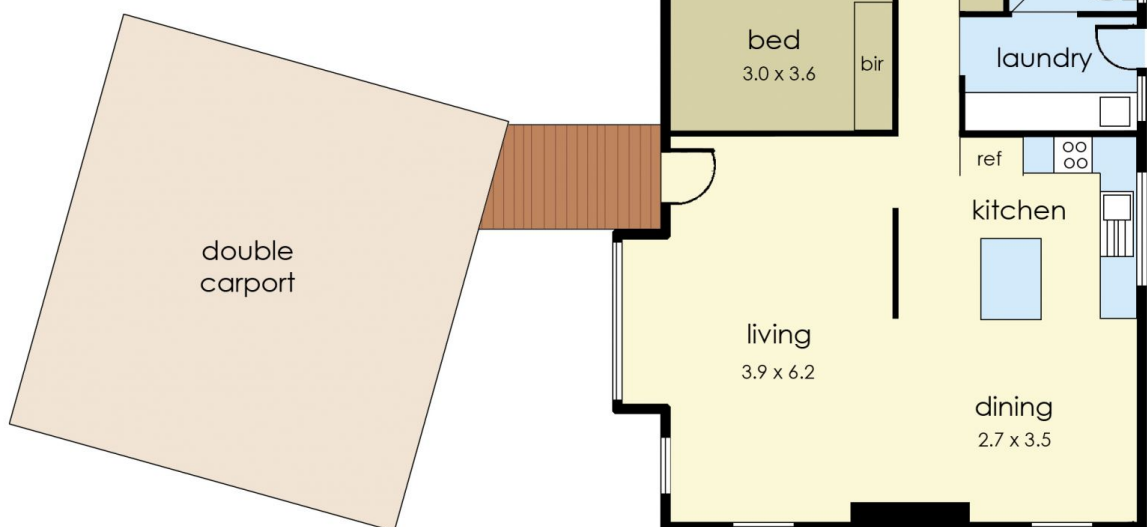
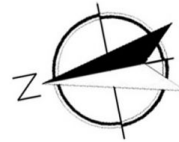

135 Canterbury Jetty Road, Rye

This floorplan is for illustration purposes only and no warranty is given to its accuracy. Purchasers are advised to carry out their own investigations.